

Transmission



TRANSMISSION COOLERS – HEAVY DUTY

- Light service – rated up to 10,000 lbs. 5" x 17" x 3/4".
 TC10ea 39.95
- Medium service – rated up to 16,000 lbs. 7 1/2" x 17" x 3/4".
 TC16ea 39.95
- Heavy service – rated up to 20,000 lbs. 10" x 17" x 3/4".
 TC18ea 49.95



A/T OIL COOLER
 100% aluminum construction with embossed plates sandwiched together to create one of the most efficient oil cooling devices available.

Equipped with threaded female pipe threads. Measures 11" x 4 1/2" x 1 1/2".
NOTE: Due to the custom nature of this installation, this cooler does not include a mounting kit, hose or fittings.

- Fits all vehicles with A/T and GVW of 13,000 to 16,000 lbs.
 70265ea 89.95



TRANSMISSION OIL PAN AND FILTER

Oil Pan
 Extra deep pan (3 1/2" deep) made from heavy aluminum. Kit includes deep pan, drain plug gasket, pipe plug, drain plug, filter extension, 3 machine screws, 3 nuts, 11 bolts, 11 flat washers, male connector, cover plate, O.D. flat washer, filter, pan gasket.

- '70 – '77 Maverick C4; '71 – '72 Comet C4.
 50281kit 179.95

- Oil Pan Filter**
 For use with oil pan #50281 above.
 '70 – '77 Maverick; '71 – '72 Comet C4.
 10288ea 15.95

- AUTOMATIC TRANSMISSION FILTER / GASKET KIT**
 Kit contains 1 gasket and 1 filter.
 '70 – '77 C4.
 K7kit 8.95



- TRANSMISSION MODULATORS (SHIFT DIAPHRAGMS)**
- '70 – '74 C4.
 1/2" – 20 thread, single hose, White stripe.
 TM9ea 15.95
- '70 – '75 FMX.
 1/2" – 20 thread, single hose, Blue stripe.
 C1AZ-7A377Bea 19.95
- '70 – '77 302 2/B.
 Black stripe.
 FM2315ea 18.95



TRANSMISSION MODULATORS (SHIFT DIAPHRAGMS) CONTINUED

- '72 – '77 '72 C4; '73 302 2/B C4; '73 – '77 6-cylinder C4; '74 – '77 8-cylinder C4.
 Yellow stripe.
 FM2317ea 19.95



- A/T TRANSMISSION INSPECTION PLATES**
- '70 – '77 Maverick 170, 200 C4; '71 – '72 Comet 200 C4.
 C5DZ-7986Aea 29.95
- '70 – '77 '70 – '75 Maverick 302 C4; '70 – '77 Maverick 250 C4; '71 – '72 Comet 250 / 302 C4.
 C5DZ-7986Bea 16.95
- '71 – '72 Comet 302 with FMX transmission.
 C5AZ-7986Aea 29.95



- TRANSMISSION DIPSTICK**
- '70 C4C6OZ-7A020Bea 19.95



TRANSMISSION DIPSTICK
 Mounts on the transmission. High-tech dipstick featuring a braided stainless steel hose. Instructions included.

- '70 – '77 C4.
 TD30C4TMea 99.95

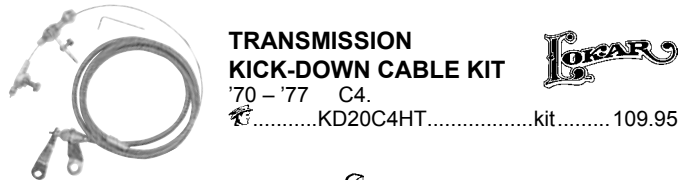

- TRANSMISSION KICK-DOWN CABLE KIT**
- '70 – '77 C4.
 KD20C4HTkit 109.95

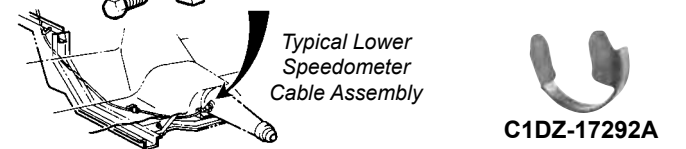
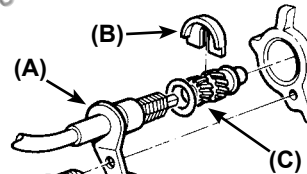

- SPEEDOMETER CABLE CLIP (A)**
 Attaches the speedometer cable to the transmission housing.
 '70 – '77 B9TZ-17264Rea 5.95

- SPEEDOMETER DRIVEN GEAR RETAINER CLIP (B)**
 C-type clip.
 '70 – '77 C1DZ-17292Aea 3.95



C5ZZ-17285A



C0DZ-17271B

SPEEDOMETER GEARS (C)

SEE DIAGRAM ON PREVIOUS PAGE

Drive Gears

LH tilt. 1 3/8" I.D., 1 13/16" O.D., 1 1/16" thick.

6 teeth. Pink.



C5ZZ-17285Aea 19.95

7 teeth. Black.



C4DZ-17285Aea 19.95

Driven Gears

LH Tilt

White (color may not be correct).

16 teeth.



C2DZ-17271-16ea 9.95

17 teeth.



C2DZ-17271-17ea 9.95

18 teeth.



C2DZ-17271-18ea 9.95

19 teeth.



C2DZ-17271-19ea 9.95

20 teeth.



C2DZ-17271-20ea 9.95

21 teeth.



C2DZ-17271-21ea 9.95

RH Tilt

16 teeth. Burgundy.



C0DZ-17271Aea 9.95

17 teeth. White.



C3DZ-17271Cea 9.95

18 teeth. Yellow.



C0DD-17271Bea 9.95

19 teeth. Pink.



C0DZ-17271Bea 9.95

20 teeth. Black.



C1DZ-17271Aea 9.95

2333



6-1605BL



TRANSMISSION MOUNTS

Distance between transmission-side mounting holes, center-to-center: 5 1/2". Distance between crossmember-side mounting studs, center-to-center: 2 3/4".

'70 - '77 2333ea 14.95

Polyurethane

Black polyurethane. Built to control torque and eliminate breakage.

'70 - '77 6-1605BLea 54.95



SHIFT IMPROVER KIT



The easy way to get better performance from your automatic transmission: faster shifts, longer clutch and band life, better fuel economy, and cooler running temperatures. Choose between two performance types: heavy duty or street / strip. Takes just a few hand tools and a few hours to improve your transmission into the solidly-tuned unit you want. Kit includes a pan gasket, specialty separator plates, twist drill and step-by-step instructions.

'70 - '77 C4 50262kit 49.95



SHIFT LINKAGE REPAIR KIT

Includes 3 each of studs, nuts, washers and pins.

'71 - '76 '71 - '73 Maverick with 3-speed; '73 - '76 Maverick, all with M/T floor shift; '71 - '72 Comet, all with M/T.

C5ZZ-7285RPKkit 22.95



TRANSMISSION CROSSMEMBER

'70 - '77 8-cylinder with C4, 3- or 4-speed toloader. Works with dual exhaust.

D0DZ-6A023ea 99.95

Transmissions by Performance Automatic®

Since 1984, Performance Automatic, Inc., the leader in Ford transmissions and components, has been driven to provide the ultimate in racing transmissions, torque converters and related parts. Countless hours have been spent researching, developing and testing their products. Performance Automatic, Inc. has been an innovator and problem solver, and complete customer satisfaction is their main goal. Every part is backed by a staff whose knowledge and expertise are second to none.

The following transmissions come with detailed instructions. Please have year, model and engine size ready when ordering.



Typical C4 Transmission

SUPER STREETER C4 TRANSMISSIONS



Can withstand 450 horsepower and includes heavy duty clutches, pro shift servo, street / strip valve body, Kevlar® band and deep aluminum pan.

ONE-YEAR WARRANTY. You pay shipping costs; Performance Automatic® will do all warranty work.

Case fill. PA26101ea 1,300.00
Pan fill. PA26102ea 1,250.00

STREET SMART C4 TRANSMISSION



Similar to their street / strip unit, but it features a hardened input shaft, power planetary and aluminum pan for firm shifts. The package includes the transmission, dipstick and filler tube, 11" torque converter and Pro Fit bellhousing, making for problem-free installation.

LIFETIME WARRANTY, NON-TRANSFERABLE. You pay shipping costs and Performance Automatic® will do all warranty work.

Case fill. PASS26103ea 1,950.00

STREET SMART SMALL-BLOCK AOD TRANSMISSION



An excellent upgrade for your earlier-model Ford. This transmission has been dyno tested and features heavy duty clutches, wide band diode pack, street / strip valve body, chrome pan, HD 3-4 clutch pack, and a shift improvement kit. Package includes the AOD transmission, TV pressure cable, 2200-2400 stall converter, dipstick and filler tube. Rated up to 450 horsepower.

LIFETIME WARRANTY (NON-TRANSFERABLE).

PASS53103ea 2,395.00

ALL TRANSMISSIONS SHIP TRUCK FREIGHT AND COULD COST BETWEEN \$100.00 AND \$200.00+ DEPENDING UPON DESTINATION.

Transmission Performance Parts by Performance Automatic®

You can go to www.performanceautomatic.com and download video instructions or print instructions for many of the following parts.

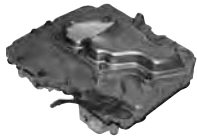

C4 STREET / STRIP VALVE BODY

Designed for everyday driving and the occasional drag strip. Automatic shifts in the drive position and will hold first and second gear manually. Direct bolt-in with no other modification required.

'70 - '77 PA26302 ea 219.00



BLOCK PLATE

Has ventilation holes provided to ensure adequate air circulation. Made from .060 steel. A removable starter spacer provides for exact starter positioning to prevent starter kick out and flywheel damage on flywheel teeth.

289, 302, 351C M/T or A/T with C4, small bellhousing C6 or AODs equipped with 157- or 164-tooth flywheel.
 PA26445 ea 95.00



HARDENED INPUT SHAFT

Made of 4340 non-twist steel. Withstands an extremely fast rate shear load.

C4 with 26 spline.
 PA26405 ea 160.00



DEEP TRANSMISSION OIL PANS - ALUMINUM

Holds more fluid for more efficient cooling. The aluminum construction makes them stronger than stock steel pans, and promotes faster heat dissipation for further cooling of your transmission. Includes pan, gasket, drain plug and attaching hardware. 7" wide x 9" long x 4" deep with PA logo.

C4 case fill.
 PA26403 ea 120.00
C4 pan fill.
 PA26404 ea 135.00



TRANSMISSION DIPSTICK AND FILLER TUBES

Has a "no leak" hat seal and lock-top stick to prevent any fluid from coming out your dipstick tube when pressure builds.

C4 case fill.
 PA26406 ea 89.95
C4 pan fill.
 PA26407 ea 84.95



FRG157N



C3AZ-6375J

FLYWHEEL RING GEAR

'70 - '77 157 teeth, 12" I. D. Replacement.
FRG157N ea 29.95

FLYWHEELS - MANUAL TRANSMISSION

'71 - '77 Maverick 302; '71 - '72 Comet 302 2/B.
 C3AZ-6375J ea 179.95

FLYWHEELS - MANUAL TRANSMISSION CONTINUED



Aluminum



Made from the highest-quality 6061 T6 aluminum, known for its strength, heat dissipation and weight reduction. The friction surface used is an incredibly strong 1050 steel and attached with military grade aerospace fasteners. The plates are milled to meet Fidanza's high specifications. The ring gears used

are also made from 1050 steel and are heat-treated for durability, then pressed on and secured with grade-8 button screws. Mates with any type of clutch material, including organic, Kevlar®, ceramic, metallic and sintered iron. SFI approved. Includes hardware and instructions.

'70 - '77 302.
164 teeth.
 186511 ea 339.95



FLYWHEEL BOLTS AND WASHERS

Includes 6 bolts and 6 washers. 7/16" - 20 x 1". Grade 8.

..... 912 set 12.95



C3DZ-6375B



E0AZ-6375A

FLEXPLATES - AUTOMATIC TRANSMISSION

'70 - '77 '70 - '72 Maverick 170, 200; '73 - '77 Maverick / Comet 200 C4.

Reproduction. Does not include ring gear.
..... C3DZ-6375B ea 22.95

'72 - '76 302 C4.
157 teeth, 10 1/2" bolt circle.

NOTE: This flexplate is for street use only, not SFI certified.
 50236 ea 89.95

'76 - '77 '76 Comet 302 with pan fill transmission; '77 Maverick / Comet 302 FMX and C4 Overdrive.

164 teeth, 12" pitch, 14.23" O.D. 28.2 oz. balance weight.
 E0AZ-6375A ea 59.95

'77 302 / 351W / 351C C4.
164 teeth, 11.4" bolt circle. 28.2 oz. balance weight.

..... 50237 ea 69.95



FLEXPLATE BOLTS AND WASHERS

Includes 6 bolts and 6 washers. 7/16" - 20 x 1 3/16".

..... 6711 set 19.95



BELLHOUSING SEPARATOR PLATE

9 bolt holes and two pin holes. Includes inspection plate.

NOTE: This will not fit smaller bellhousings with 157-tooth flexplates.

'71 - '73 302 C4 with 164-tooth flexplate.
 C9DZ-7007/7986 ea 49.95

DRIVE SHAFT YOKES

For small-block V8. No specific applications are available. Please check measurements before ordering.

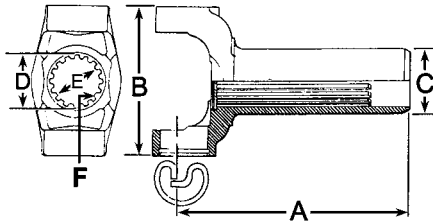

- (A) Length from center or u-joint hole to end of shaft: 8³/₃₂"
- (B) Outside-to-outside length of u-joint: 3¹/₂"
- (C) O.D. of shaft: 1¹/₂"
- (D) I.D. of shaft to spline: 1⁹/₃₂"
- (E) I.D. of spline: 1³/₃₂".
- (F) 28 splines. Uses an outer lock ring.
..... C3AZ-4841Dea 89.95

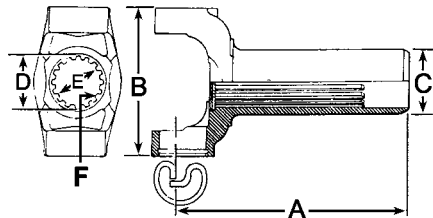

- (A) Length from center or u-joint hole to end of shaft: 7³/₄"
- (B) Outside-to-outside length of u-joint: 3¹/₂"
- (C) O.D. of shaft: 1¹/₂"
- (D) I.D. of shaft to spline: 1⁷/₁₆"
- (E) I.D. of spline: 6³/₆₄".
- (F) 25 splines. Uses an outer lock ring.
..... C3DZ-4841Aea 89.95

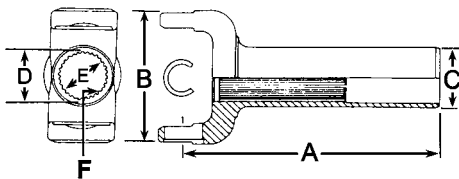

- (A) Length from center or u-joint hole to end of shaft: 8³/₃₂"
- (B) Outside-to-outside length of u-joint: 3¹/₂"
- (C) O.D. of shaft: 1¹/₂"
- (D) I.D. of shaft to spline: 1⁹/₃₂"
- (E) I.D. of spline: 1³/₃₂".
- (F) 28 splines. Uses an inner c-clip.
..... C5DZ-4841Aea 89.95

Clutch

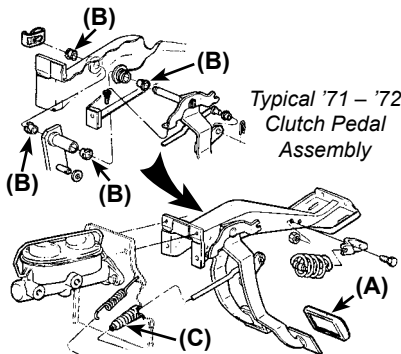

- CLUTCH PEDAL PAD AND TRIM (A)**
- '70 - '77 Pad C5ZZ-7A624Bea 3.95
 - Trim C5ZZ-7B544Aea 6.95



C5ZZ-7A624B



C5ZZ-7B544A



CLUTCH PEDAL ARM MOUNTING BRACKET BUSHING (B)

- '70 - '77 Requires 2 per arm.
..... B7AZ-2471Bea 1.95



1508BUSH



C5ZZ-2478RB

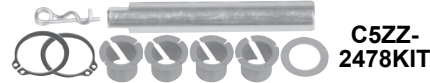

C5ZZ-2478KIT

CLUTCH PEDAL SUPPORT REPAIR KITS



Bushings Kits

Kit includes 2 plastic bushings, 2 snap rings and 2 metal sleeves.

- '70 - '77 M/T.
Without roller bearings and metal sleeves.
..... 1508BUSHkit 19.95
- With roller bearings and metal sleeves.
..... C5ZZ-2478RBkit 39.95

Support Rebuild Kit

Replacement style. Kit includes 4 plastic bushings, 2 metal sleeves, 1 retainer pin, 1 flat washer, 2 snap rings, and 1 pedal support shaft (5/8" diameter x 4 1/4" long).

- '70 - '73 M/T.
..... C5ZZ-2478KITkit 39.95



CLUTCH PEDAL ROD-TO-FIREWALL SEAL (C)

- '70 - '77 '70 - '77 Maverick 6- or 8-cylinder; '71 - '72 Comet 6- or 8-cylinder; '73 - '77 Comet 8-cylinder.
..... C6OZ-7A533Cea 10.95

Typical '71 - '72 302 Clutch Equalizer

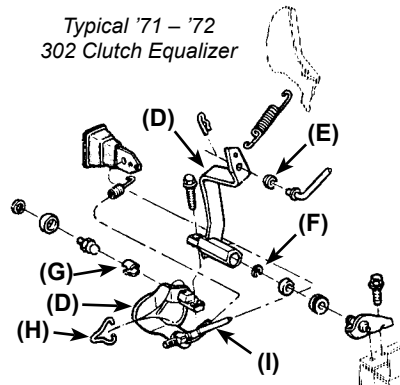

D1DZ-7528AB



C0AZ-7526B



C1DD-7A629A

CLUTCH EQUALIZER PARTS

Clutch Release Equalizer Bar (D)

- 2 piece as original.
- '70 - '77 302.
..... D1DZ-7528ABea 199.95

Idler Lever Bushing (E)

- 3/8" I.D.
- '70 - '77 C0AZ-7526Bea 2.95

Shaft Bearing Retainer (F)

- Reproduction.
- '70 - '77 C-type.
..... C1DD-7A629Aea 4.50

Typical '71 - '72
302 Clutch Equalizer

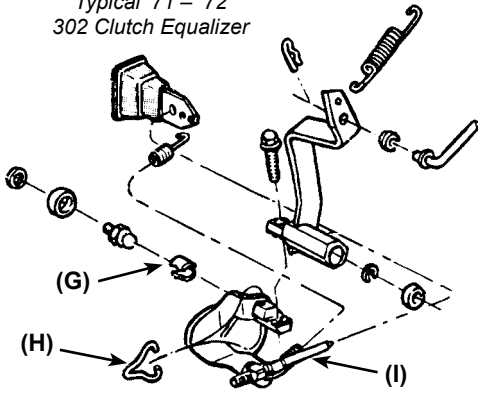

CLUTCH EQUALIZER PARTS CONTINUED

Equalizer Bar Split Bushing (Socket) (G)

2-piece bushing to replace the original 1-piece socket.

'71 - '77 6- or 8-cylinder.
 ⚙️ C5AZ-7543C ea 24.95

Ball - At Clutch Release Equalizer Bar

'70 - '77 6-cylinder.
 ⚙️ C1DD-7543A ea 2.95

Equalizer Bar Bushing Retainer Clip (H)

Hold the C5AZ-7543C bushing in the equalizer bar.

'71 - '77 8-cylinder.
 ⚙️ C5AZ-7B545A ea 10.95



Equalizer Bar Bushing and Clip Kit

Includes 2 felt washers, ball bushing (frame mount side) and C-clip, two-piece socket bushing (engine mount side), and spring clip.

'71 - '77 8-cylinder.
 ⚙️ C5AZ-7543CKIT kit 32.95



Clutch Equalizer Bar Repair Kit

Includes 2 felt washers, 2 nylon ball bushings, 2 clevis clips and 1 metal washer.

'70 - '77 '70 - '77 Maverick 6-cylinder; '71 Comet 250 / 302.
 ⚙️ C1DD-7543KIT kit 14.95

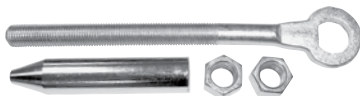

Clutch Release Lever Rod (I)

Includes rod, 2 nuts and tip. Adjustable replacement.

'71 - '74 '71 - '72 302; '73 - '74 6-cylinder with 3-speed transmission.
 D3TZ-7521A ea 12.95

CLUTCH EQUALIZER PARTS CONTINUED



Clutch Equalizer Bar-to-Clutch Release Lever Rod Lower Adjustment Swivel

'70 - '75 Maverick 200 / 250 / 302 before 12/16/74; '71 - '75 Comet 302 before 12/16/74; '72 - '75 Comet 200 / 250 before 12/16/74.
 1 5/8" long, 3/8" hole.
 Not threaded.

⚙️ D1DZ-7A528A ea 16.95



C8OZ-7522A C8AZ-7522A

CLUTCH RELEASE LEVER PIVOT BRACKETS

Attaches to the bellhousing. Includes attaching hardware.

'71 - '72 '72 Maverick; '71 - '72 Comet All with 6-cylinder.
 L-shaped. 7/8" x 1 1/16" x 1 15/16" wide.
 ⚙️ C8OZ-7522A ea 22.95

'72 - '77 8-cylinder with clip-type lever.
 ⚙️ C8AZ-7522A ea 26.95

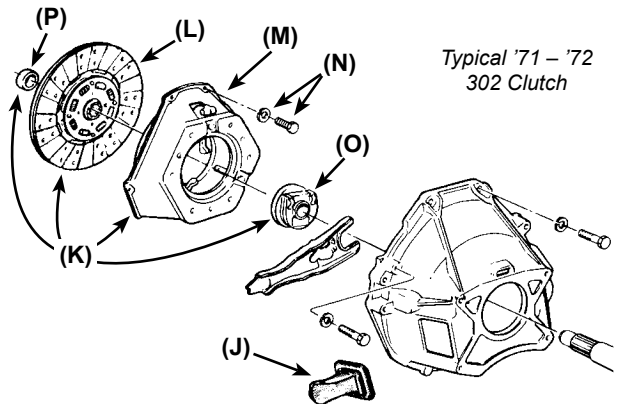

Typical '71 - '72
302 Clutch



C6OZ-7513C C6GY-7513A

CLUTCH RELEASE LEVER DUST SHIELDS (J)

'71 - '72 '71 Comet 302; '72 Maverick 302; '72 Comet 250.
 ⚙️ C6OZ-7513C ea 19.95

'73 - '77 6-cylinder.
 ⚙️ C6GY-7513A ea 19.95



**Join the
Maverick Comet Club
International!**

- Meet other Maverick and Comet owners and share information
- Receive the club's bimonthly newsletter, *Shorthorns*
- Participate in the annual Nationals, as well as mini-meets

Membership application can be found in the back of this catalog.

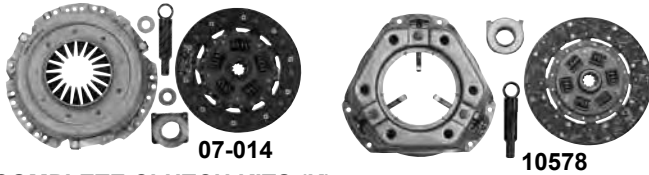

COMPLETE CLUTCH KITS (K)

SEE DIAGRAM ON PREVIOUS PAGE

Diaphragm style. Kit includes a high quality clutch and disc assembly, release bearing, pilot bearing and alignment tool.

'70 - '74	'70 - '74 Maverick / Comet 250; '71 - '74 Comet 302. Diaphragm style. 10" O.D. disc with 1 1/16", 10-tooth spline. 07-014.....kit..... 169.95
'71 - '77	'75 - '77 Maverick 250; '71 - '77 Comet 250. Diaphragm style. 10" O.D. disc with 1 1/16", 10-tooth spline. ☛ 10030.....kit..... 109.95
'71 - '77	Comet 200. Lever style. 9" O.D. disc with 1 5/16", 10-tooth spline. ☛ 10578.....kit..... 239.95
'74 - '77	Maverick 250. Diaphragm style. 10" O.D. disc with 1 1/16", 10-tooth spline. 90216.....kit..... 139.95



10" CLUTCH DISC (L)

SEE DIAGRAM ON PREVIOUS PAGE

Diaphragm style.

For pressure plate use part #CF360030 listed in the next column.

For Dual Friction® kit with 90% holding capacity, see part #DF490030 listed in the next column.

Requires throwout bearing #N1714 in the next column.

NOTE: OE clutch may be 10 1/2".

'73 - '77	250, 302. ☛ 280490.....ea 149.95
-----------	---



PRESSURE PLATE (M)

SEE DIAGRAM ON PREVIOUS PAGE

Centerforce® offers 30% more holding capacity than a stock OEM clutch while maintaining a stock pedal feel. This system (280490 and CF360030) is recommended as the finest quality "upgrade" from the original clutch.

Must be used with clutch disc #280490.

Requires throwout bearing #N1714 below.

'73 - '77	250, 302. ☛ CF360030ea 199.95
-----------	--

NOTE: We have marked with a ☛ those parts which also fit corresponding Mercury models, such as Comet.

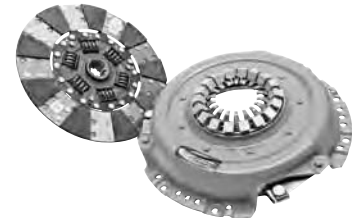

10" CLUTCH DISC / PRESSURE PLATE SET



This Centerforce Dual Friction® System generates up to 90% increase in holding capacity over stock systems. Suitable for engines producing high horsepower and torque as well as high performance street vehicles.

Requires throwout bearing #N1714 below.

Diaphragm style.

NOTE: OE clutch disc may be 10 1/2".

'73 - '77	250, 302. ☛ DF490030set..... 399.95
-----------	--



PRESSURE PLATE BOLTS AND WASHERS (N)

SEE DIAGRAM ON PREVIOUS PAGE

Includes 6 bolts and 6 washers. 5/16" - 18 x 1". Grade 8.

'70 - '77	V8 911set..... 13.95
-----------	----------------------------------



THROWOUT BEARING (O)

SEE DIAGRAM ON PREVIOUS PAGE

Use with Pressure Plate #CF360030, Clutch Disc / Pressure Plate Set #DF490030 and Clutch Disc #280490 listed in the previous column.

'73 - '77	250, 302. ☛ N1714ea 44.95
-----------	--



PILOT BEARING (P)

SEE DIAGRAM ON PREVIOUS PAGE

'70 - '77 '70 - '73 170, 200, 250, 302 351W; '74 200, 302 before 4/74; '75 - '77 Maverick 200.

☛ FC65662ea 18.95



CLUTCH PILOT BUSHING

'71 - '77 '72 - '77 Maverick 250 or 302; '71 - '77 Comet with 250 or 302.

☛ N20ea 5.95

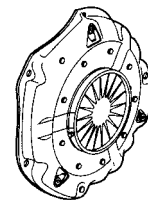

Diaphragm Style Clutch

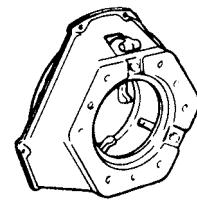

Lever Style Clutch

Not sure of a term used here?
Check out the Glossary in the back of this catalog.

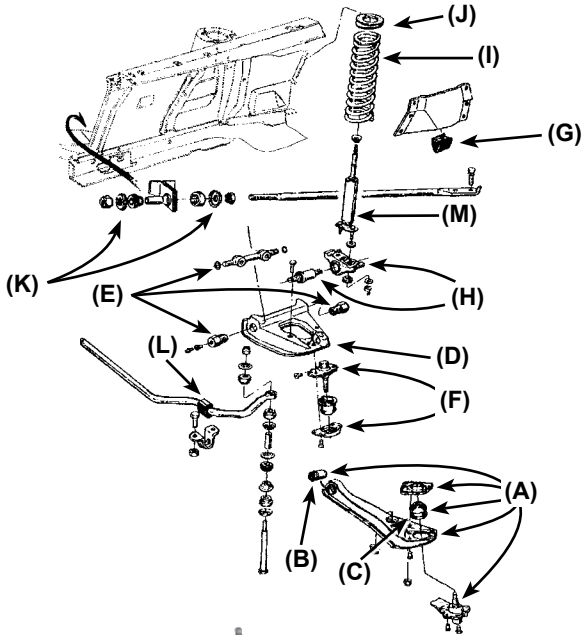

LOWER CONTROL ARM ASSEMBLIES (A)

Includes 3 cotter pins, 2 washers, 1 castle nut, and 1 grease fitting.

'70 - '77	Made in the USA.		
		K8123	ea 89.95
	Import.		
		10812	ea 59.95



LOWER CONTROL ARM SHAFT BUSHINGS (B)

Used with lower control arm shaft kit #K8243A below.

With Metal Shells

Requires 2 per vehicle.

'70 - '77	1 7/16" O.D.		
		12268	ea 15.95
	1 7/16" O.D.		
		FB292	ea 18.95
	1 9/16" O.D.		
		FB365	ea 14.95

Without Metal Shells

Urethane. Must reuse existing outer metal shells.

'70 - '77	1 7/16" O.D.		
		43102G	set..... 16.95
	1 9/16" O.D.		
		43106G	set..... 19.95



LOWER CONTROL ARM SHAFT KIT

Includes 2 shafts, 2 cams, 2 nuts and 2 washers. Used for camber adjustment.

'70 - '77	Kit does 1 vehicle.		
		K8243A	kit..... 24.95



**LOWER BALL JOINT
DUST BOOT COVER (C)**

'70 - '77 Maverick after 7/14/69; '71 Comet.
C7OZ-3A105Aea 8.95



UPPER CONTROL ARM ASSEMBLY (D)

Aftermarket. 3-rievet ball joint with natural rubber boot. Import.

'70 - '77		C7OZ-3082	ea 89.95
-----------	--	-----------	----------------



UPPER CONTROL ARM SHAFT KIT (E)

Includes the upper control arm shaft, 2 bolts, 2 nuts, 2 large bushings, 2 o-rings and 2 grease fittings. Made in the USA.

'70 - '77	Requires 2 kits per vehicle.		
		13173A	kit..... 59.95

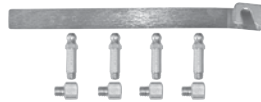

**UPPER CONTROL ARM
GREASE FITTING KIT**

The most effective way to eliminate the squeaking the upper control arm bushing commonly makes when dried up. Regular 90° fittings do not fit between the control arm and the shock tower wall. Our special 2-piece 90° grease fittings and positioning wrench eliminate the need to destroy shock towers in order to inject grease into these bushings. Includes wrench for access where space is limited, instructions and 4 grease fittings.

'70 - '77		610-041	kit..... 19.95
-----------	--	---------	----------------

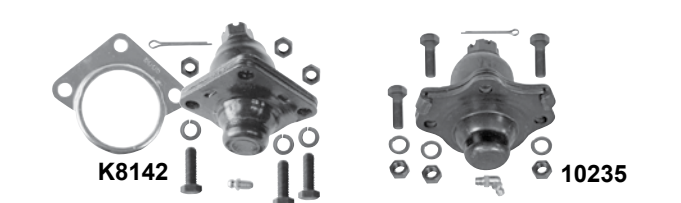
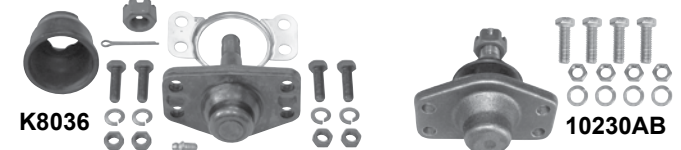

UPPER BALL JOINTS (F)

Includes mounting hardware.

'70	Before 7/14/69.		
	4 bolt.		
	Moog	K8036	ea 34.95
	Import	10230AB	ea 19.95
'70 - '77	Maverick after 7/14/69; '71 - '77 Comet.		
	3 bolt.		
	Moog.		
		K8142	ea 39.95
	Import.		
		10235	ea 19.95



UPPER FRONT SUSPENSION BUMPER (G)

Mounts on outer shock tower / coil spring cover. Rubber. Includes nut.

'70 - '77	Requires 2 per vehicle.		
		C9OZ-3020	ea 8.95



C4DZ-3388A



C4DZ-3388RR

FRONT COIL SPRING SEATS (H)

SEE DIAGRAM ON PREVIOUS PAGE
Bolts to upper control arm. Includes bushing.

- '70 - '77 Replacement. Black.
 - C4DZ-3388Aea 29.95
 - Aftermarket. Gold anodized with red nitrile rubber bushing and insulators.
 - C4DZ-3388RRea 39.95



Typical Coil Springs

C4DZ-5415A

C4DZ-5415U

OVER SIZE

COIL SPRINGS (I) SEE DIAGRAM ON PREVIOUS PAGE

Standard springs. Please specify year, engine size and with or without Grabber option when ordering. Sold in pairs.

NOTE: These are oversized items. Additional shipping charges apply.

- '70 - '77starts at.. 99.95

COIL SPRING TOP INSULATORS (J)

SEE DIAGRAM ON PREVIOUS PAGE

- '70 - '77 Rubber.
 - C4DZ-5415Aea 4.95
 - Polyurethane. Set of 2.
 - C4DZ-5415Upr 21.95

NEW



K8157

47112G

STRUT ROD BUSHING KITS (K)

SEE DIAGRAM ON PREVIOUS PAGE

- '70 - '77 With midolyne bushings. Includes hardware.
 - K8157kit 32.95
 - With polyurethane bushings. Does not include hardware.
 - 47112Gkit 28.95

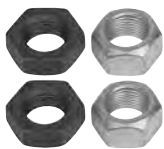

STRUT ROD NUT SET

For the under-body end of the strut rod. Includes two inner nuts (1 1/16" - 18 x 1 1/8", serrated) and two outer nuts (1 1/16" - 18 x 1").

- '71 - '77
 - AK1031set 14.95



K8097

98117G

SWAY BAR END LINK KITS

Includes 1 bolt, 4 bushings, 4 washers, 1 sleeve and nut(s). Requires 2 kits per vehicle.

Rubber Bushings

- '70 - '76 K8097kit 9.95
- '76 - '77 K440kit 8.95

Polyurethane Bushings

- '70 - '77 98117Gkit 24.95



AD835U

SWAY BAR KITS

Non-stock replacement. Gloss metallic black powder coat finish. Complete kits with installation hardware. 7/8". Mounts in existing holes. Polyurethane bushings. Allow 2 to 3 weeks for delivery.

- '70 - '77 Front.
 - AD835Uea 276.95
 - Rear.
 - AD264Uea 241.95

SWAY BAR MOUNTS (L)

SEE DIAGRAM ON PREVIOUS PAGE

Included with sway bars or can be purchased separately.



54935/8

54937/8

Without Brackets

Rubber bushings only.

- '70 - '77 With 5/8" bar 54935/8pr 14.95
- With 1 1/16" bar 54931 1/16pr 14.95
- With 3/4" bar 54933/4pr 14.95
- With 7/8" bar 54937/8pr 19.95
- With 1 1/16" bar 549315/16pr 19.95
- With 1" bar 54931pr 14.95



- '70 - '77 With 5/8" to 1 1/16" bar.
 - K5227pr 10.95



95105G

95108G



95112G

With Brackets

Polyurethane. Includes brackets and bushings.

- '70 - '77 With 1 1/16" bar.
 - NOTE:** Must drill new holes. The brackets do not line up.
 - 95105Gkit 22.95
 - With 3/4" bar.
 - NOTE:** Must drill new holes. The brackets do not line up.
 - 95106Gkit 22.95
 - With 7/8" bar.
 - 95108Gkit 21.95
 - With 1 1/16" bar 95109Gkit 21.95
 - With 1" bar 95110Gkit 22.95
 - With 1 1/8" bar 95112Gkit 22.95



NEW

FRONT SUSPENSION LOWER CROSSMEMBER

Improves your handling by giving you greater stability and more strength in the front end. Fits under your vehicle and bolts to the under-side of the frame rail, just behind the shock tower.

- '71 - '77 302.
 - D0DZ-5025Aea 79.95

SHOCKS (M) SEE DIAGRAM ON PAGE 58

NOTE: Shock absorbers contain compressed gasses and must be shipped using only ground services. No air shipments will be allowed.

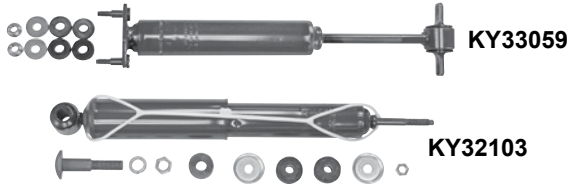

Monroe-Matic Plus® Gas Shocks



Made in the USA

Combines exclusive position-sensitive pressure tube grooves with specially-tuned valving to improve the riding and handling characteristics of the vehicle. Adapts more rapidly to changing road and weight conditions.

'70 - '77	Front.		
		KY33059	ea 24.95
	Rear.		
		KY32103	ea 24.95

Max-Air® Gas Shocks



Made in the USA

Monroe Max Air® shock absorbers have large air chambers that inflate up to 150 PSI. Contains all-weather fluid that ensures smooth reaction for the 1/2" piston rod. Features sintered iron pistons

for durability and air fittings that resist air leakage. Includes mounting hardware and air line installation kit.

'70 - '77	Rear.		
		MA709	ea 89.95

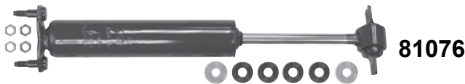
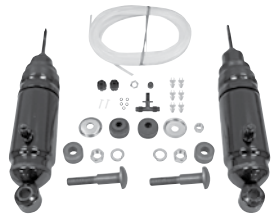

Gabriel® Shocks



Made in the USA

Includes hardware.

'70 - '77	Front.		
		81076	ea 34.95
	Rear.		
		82130	ea 34.95



KYB® Excel-G Premium Shocks



Made in Japan

Designed to compensate for worn suspensions and built with components and valving for these specific applications. This shock is your best choice for OE replacement and normal driving conditions.

'70 - '77	Front.		
		343146	ea 39.95
	Rear.		
		343136	ea 49.95

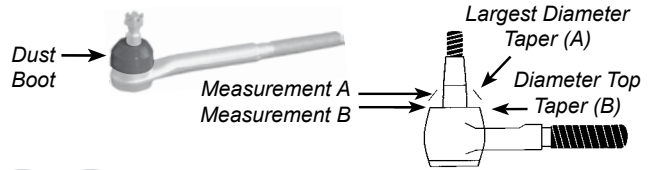

TIE ROD END DUST BOOTS - POLYURETHANE

Replace your tie rod dust boot without having to buy a new tie rod end. Made from high-quality black polyurethane, these new dust boots will help resist damage from rocks, sand, water, road salt, and oils by sealing the tie rod end to prevent loss of lubricants - the major cause of tie rod wear.

Measure the rod end per the diagram shown to find the closest fit.

'70 - '77	Dimension A = 3 1/64" or .472" or 12 mm.	
	Dimension B = 1 13/64" or 1.200" or 30.5 mm.	
		913103G pr 5.95
'70 - '77	Dimension A = 1 9/64" or .590" or 15 mm.	
	Dimension B = 1 3/8" or 1.375" or 35 mm.	
		913101G pr 5.95

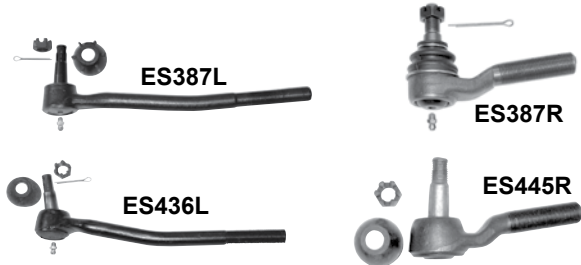
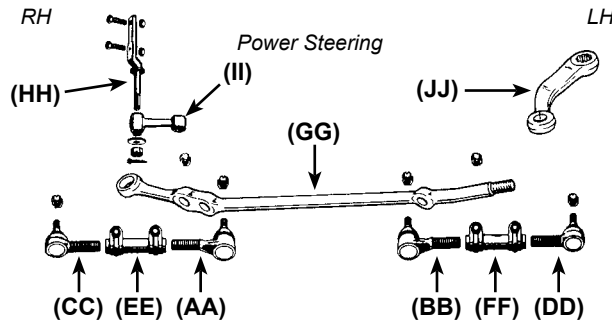
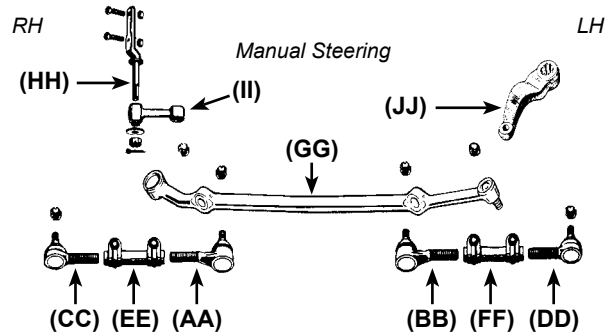

TIE ROD ENDS

Includes cotter pin, castle nut, grease fitting and dust boot.

'70 - '74	Inner. LH or RH.		
	(AA) (BB)	ES387L	ea 69.95
		Import.	
	(AA) (BB)	ES387LS	ea 19.95
'70 - '74	Outer. LH or RH.		
	(CC) (DD)	ES387R	ea 39.95
'75 - '77	Inner. LH or RH.		
	(AA) (BB)	ES436L	ea 69.95
	Outer. LH or RH.		
	(CC) (DD)	ES445R	ea 32.95



TIE ROD END CONNECTING SLEEVES (EE) (FF)

SEE DIAGRAM ON PREVIOUS PAGE
Includes 2 nuts and 2 bolts. Required 2 per vehicle.

'70 - '72	Maverick; '71 - '72 Comet. LH or RH.		
	ES2004S.....ea	9.95
'72 - '77	LH or RH.		
	ES426S.....ea	22.95



RP25821



RP25881



RP25914

CENTER LINKS (DRAG LINKS) (GG)

SEE DIAGRAM ON PREVIOUS PAGE

'70 - '74	M/S. Remanufactured.		
	RP25821.....ea	219.95
	Core fee	RP25821CORE	75.00
'75 - '77	M/S. No core required.		
	RP25881.....ea	139.95
'75 - '77	P/S.		
	RP25914.....ea	106.95
	Core fee	RP90003.....ea	110.00



K8150



K8245



K8103

IDLER ARM ASSEMBLIES (HH)

SEE DIAGRAM ON PREVIOUS PAGE
Made in the USA.

'70 - '74	Maverick M/S; '71 - '74 Comet M/S.		
	K8150.....ea	89.95
'75 - '77	K8245.....ea	59.95

IDLER ARM BUSHING (II) SEE DIAGRAM ON PREVIOUS PAGE

Center link end.

'70 - '77	K8103.....ea	14.95
-----------	-------	--------------	-------



PITMAN ARM (JJ) SEE DIAGRAM ON PREVIOUS PAGE

'75 - '77	M/S.		
	RP20130.....ea	99.95



PITMAN ARM-TO-STEERING GEAR NUT

Holds the pitman arm to the steering gear sector shaft.
7/8" - 14. 15/16" hex.

'70 - '77	With 1 1/8" sector shaft.		
	AK1032.....ea	4.95

Rebuilt Power Steering Components

**** Call our Rebuild Department to place an order and for any questions concerning rebuilds. ****

These premium remanufactured units carry a manufacturer's limited lifetime warranty against defects in material or workmanship for as long as you own your vehicle. We will repair or replace ANY remanufactured steering component found to be defective due to the failure of material or workmanship in our judgement. This warranty does NOT cover operator negligence, misuse, accidents, improper installation, changes in adjustments or disassembly.

Please allow 3 to 4 weeks plus shipping to rebuild the unit. Core fees are in addition to the price of the unit and are refundable in 3 to 4 weeks after receiving a rebuildable core.

*** ALL CORES MUST BE RETURNED COMPLETE WITHIN 60 DAYS TO RECEIVE A FULL REFUND ***

NOTE: There will be an additional cost for replacement parts, such as ball stud, end cap, worm gear, or sector shaft.



CV8535 / CV8536



CV8535
Port Detail



CV8536
Port Detail

CONTROL VALVE REBUILDS

If your control valve needs the ball stud or end cap replaced, you will be notified. Additional cost for the ball stud is \$18.00, additional cost for the end cap is \$20.00.

'70 - '76	Before 4/5/76. Flared fitting.		
	CV8535.....ea	159.95
	Core for above		200.00
'76 - '77	After 4/5/76. O-ring fitting.		
	CV8536.....ea	149.95
	Core for above		150.00



POWER CYLINDER REBUILDS

When necessary, shafts are replaced at no extra charge. Rebuild includes boot insulator kit #C3AZ-3C651A below.

NOTE: Customer must supply core to be rebuilt.

'70 - '77	PCRB.....ea	159.95
-----------	-------	-------------	--------



POWER CYLINDER BOOT INSULATOR KIT

Accordion-type sleeve, approximately 9" long but compresses to 3", extends to 12". Includes 2 washers, 2 bushings and 1 retaining ring. This kit is included in the power cylinder rebuilds above.

'70 - '77	C3AZ-3C651A.....kit	14.95
-----------	-------	---------------------	-------



POWER CYLINDER SEAL KIT

Includes all the necessary seals and bushings when a power cylinder rebuild is done.

'70 - '77	2745.....kit	19.95
-----------	-------	--------------	-------



**POWER CYLINDER
BALL STUD END
BOOT AND CLAMP**

'70 - '71
C5ZZ-3A540Bea 14.95



**STEERING COUPLER REPLACEMENT
KIT (RAG JOINT)**

Helps prevent steering wheel shimmy and vibration and tightens up loose steering. Kit includes disc, nuts, bolts and washers. Requires 1 kit.

'70 - '77
31000kit 9.95

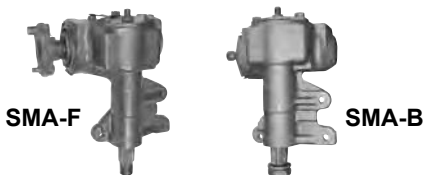

SMA-F

SMA-B

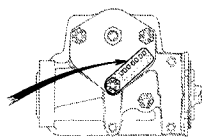

Typical Gear Box Tag
Number Location

**REMANUFACTURED
GEAR BOXES**

Rebuild consists of new bushings, bearings and seals. The worm gear and sector shaft are polished and inspected to ensure quality, and the gear box is set to original specifications. If the worm gear or sector shaft need replacing, you will be notified. If available, these parts

can be replaced for an additional charge.

**** MUST HAVE TAG NUMBER READY WHEN ORDERING ****

'70 - '77	7 ³ / ₁₆ " input shaft.		
	M/S.		
		SMA-F.....ea	219.95
	Core feeea	150.00
	P/S.		
		SMA-B.....ea	219.95
	Core feeea	150.00



P131

P133

P136

POWER STEERING PUMP REBUILDS

'70 P131ea	109.95	
	Core for above P131COREea	100.00
'71 - '74	6-cylinder..... P131ea	109.95	
	Core for above P131COREea	100.00
'71 - '74	V8..... P133ea	109.95	
	Core for above P133COREea	100.00
'75	6-cylinder..... P136ea	109.95	
	Core for above P136COREea	100.00
'75	V8.			
	Without A/C P133ea	109.95
	Core for above P133COREea	100.00
'76 - '77	6-cylinder.			
	Flared fitting P307ea	109.95
	Core for above P307COREea	75.00
'76 - '77	V8.			
	Flared fitting P313ea	109.95
	Core for above P313COREea	75.00
	O-ring fitting..... P308ea	109.95	
	Core for above P308COREea	75.00

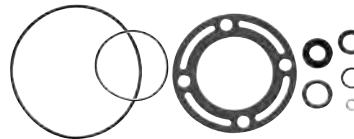

POWER STEERING PUMP SEAL REPAIR KIT

'70 - '77 With Ford pump.
2773kit 19.95



C7AZ-3A006B

C7AZ-3A006C

POWER STEERING PUMP CAPS AND DIPSTICKS

'71 - '72 Comet.
Zinc.
C7AZ-3A006Bea 16.95
Chrome.
C7AZ-3A006Cea 19.95



CONTROL VALVE

New, not remanufactured. No core fee.

'70 - '76 FR8535ea 279.95

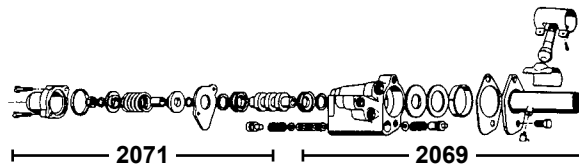

2071

2069



2071

2069

POWER STEERING CONTROL VALVE REPAIR KITS

Control Valve Seal Kit

Includes all the necessary seals required when a control valve rebuild is done. Kit includes paper seal, 2 plastic washers, 3 o-rings, nut, 2 rubber seals and 2 rubber grommets.

'70 - '77 2071kit 19.95

Control Valve Ball Stud Kit

Kit includes spring, 2 ball stud seats, ball stud, bracket, 2 screws, and 3 gaskets.

'70 - '77 2069kit 34.95



Control Valve Seal and Ball Stud Repair Kit

Combines seal kit #2071 and stud kit #2069. Includes all the necessary seals required when a control valve rebuilt, plus the ball stud, ball stud seats, spring, ball stud seal and bracket with screws. Ball stud socket sold separately (see part #C1AA-3A754C below).

'70 - '77 5060kit 49.95



**POWER STEERING CONTROL VALVE
SOCKET BALL STUD**

'70 - '72
C1AA-3A754Cea 23.95



POWER STEERING CONTROL VALVE TUBE SEATS **NEW**

Aluminum. Includes (3) 5/16" tube seats and (1) 3/8" tube seat.
 '70 - '76 372896/373430SET set 16.95



POWER-TO-MANUAL STEERING CONTROL VALVE ELIMINATOR

A hassle-free, economical method for converting from power steering to manual steering. Simply remove the control valve and thread this adapter on in its place. Complete with instructions and is

ready to install. Greaseable and includes an original-looking rubber seal.
 '70 - '77 '70 - '77 Maverick with P/S; '71 - '75 Comet with P/S.
 RP27483 ea 159.95

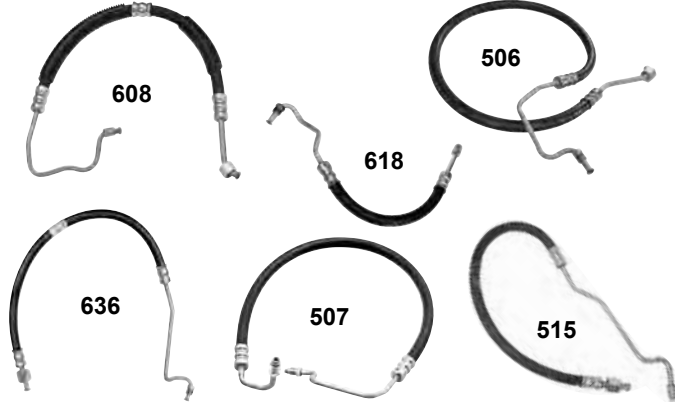

POWER STEERING HOSES

Pressure Hoses

'70 - '74	'70 - '72 170, 200, 250; '73 - '74 250. 36 1/2" long with 3/8" female S.A.E. x 5/16" male inverted flare. 608 ea 29.95
'70 - '75	250 without hydro-boost. 51 3/4" long with 3/8" female S.A.E. x 5/16" male inverted flare. Flared fitting. 506 ea 39.95
'71 - '74	302. 22" long with 3/8" male inverted flare x 3/8" male S.A.E. Pump end. 618 ea 29.95
'71 - '75	302. 30" long with 3/8" female S.A.E. x 5/16" male inverted flare. Valve end. 636 ea 29.95
'75	250. Flared fitting. 51 3/4" long with 3/8" female S.A.E. x 5/16" male inverted flare. 506 ea 39.95
'75	8-cylinder. Valve end. 30" long with 3/8" female S.A.E. x 5/16" male inverted flare. 636 ea 29.95
'76	200, 250 before 4/5/76 without hydro-boost. Flared fitting. 51 3/4" long with 3/8" female S.A.E. x 5/16" male inverted flare. 506 ea 39.95
'76	302 with o-ring pump and flared gear fittings or flared pump and gear fittings. Fits to gear. 30" long with 3/8" female S.A.E. x 5/16" male inverted flare. Valve end. 636 ea 29.95
'76	6-cylinder after 4/5/76 with o-ring fittings. 40 1/2" long, 3/8" male o-ring x 5/16" male o-ring. 507 ea 29.95
'76	302 after 5/6/76 with o-ring fittings. Valve end. 30 1/2" long x 3/8" female S.A.E. x 5/16" male o-ring. 515 ea 26.95
'77	6-cylinder. 40 1/2" long, 3/8" male o-ring x 5/16" male o-ring. 507 ea 29.95

POWER STEERING HOSES CONTINUED

Pressure Hoses Continued

'77	302. Valve end. 30 1/2" long x 3/8" female S.A.E. x 5/16" male o-ring. 515 ea 26.95
-----	---

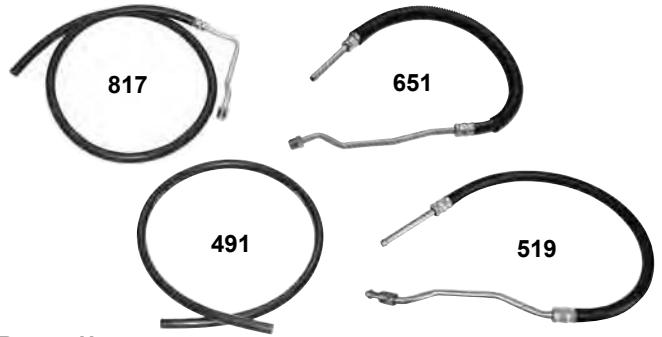

Return Hoses

'70 - '74	Maverick all 6-cylinder; Comet 170, 200, 250. 55 1/2" long with 3/8" male inverted flare. 817 ea 24.95
'70 - '75	8-cylinder. Valve end, return from gear. 32 3/4" long with 3/8" male inverted flare x 3/8" bead. 651 ea 19.95
'70 - '77	Maverick 302 491 ea 14.95
'71 - '72	Maverick / Comet 302. Pump end. 903-14 ea 9.95
'73 - '74	All 6-cylinder after 12/21/72. Cooler to pump. 903-16 ea 12.95
'73 - '74	8-cylinder. Pump end. 903-12 ea 9.95
	Cooler to pump. 903-9 ea 8.95
'75	200, 250. 55 1/2" long with 3/8" male inverted flare. 817 ea 24.95
'75	8-cylinder. Pump end. 903-15 ea 9.95
	Cooler to pump. 903-11 ea 9.95
'75 - '76	6-cylinder. Cooler to pump. 903-24 ea 12.95
'76	8-cylinder before 1/5/76 with flared gear fitting. From gear. 32 3/4" long with 3/8" male inverted flare x 3/8" bead. Valve end. 651 ea 19.95
'76	200, 250 with flared fitting. 55 1/2" long with 3/8" male inverted flare. 817 ea 24.95
'76 - '77	8-cylinder with o-ring fitting. Pump end 903-26 ea 12.95
'76	302 with o-ring fittings. From gear. 33 1/4" long with 3/8" male o-ring x 3/8" bead. 519 ea 19.95
'77	302. From gear. 33 1/4" long with 3/8" male o-ring x 3/8" bead. 519 ea 19.95



Control Valve-to-Cylinder Hoses

'70 - '74	9 1/2" long with 3/16" male inverted flare x 5/16" male inverted flare. Composed of one #C6OZ-3A714A (to cylinder) hose and one #C6OZ-3A717A (to control valve) hose. Requires 1 pair per vehicle. C6OZ-3A714/7PR pr 59.95
-----------	--

POWER STEERING HOSES CONTINUED



Control Valve-to-Cylinder Hoses Continued

'76	200, 250 after 4/5/76; 302 from 1/5/76 to 5/6/76 o-ring fitting. Requires 2. 10 ³ / ₄ " long with 5/16" male o-ring × 5/16" male o-ring.	523	ea	19.95
'77	302. Pump end.	523	ea	19.95



POWER STEERING HOSE INSULATOR

Molded rubber, which resists hardening and cracking.
'71 - '72 Maverick; '73 - '75 Maverick without hydro boost and skid control; '76 - '77 Maverick; '71 Comet.
C7ZZ-3A609Aea 9.95

INTEGRAL POWER STEERING CONVERSION KITS

Upgrade your stock steering with these complete integral power steering conversion kits. Kits include all components necessary for conversion.

IMPORTANT INSTALLATION NOTES:

- Steering column must be shortened to fit conversion box.
- Steering column modifications can be extensive on column shift cars.
- Power conversion box will not fit with factory clutch linkage.
- Does not include instructions. We recommend an experienced person with the understanding of modifications to do this installation.

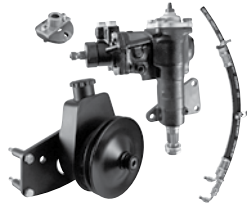

Manual-to-Power Kit

Upgrades manual steering to integral power steering. Kit includes integral power steering box, universal joint / rag joint, power steering pump kit (pump, mounting bracket, pulley), and hose kit.

'70 - '77	289, 302, 351W.	6571FARKTMS8	kit	1,095.00
-----------	-----------------	--------------	-----	----------

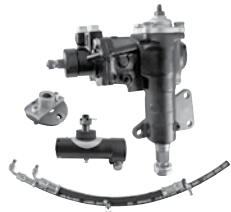

Power Assist-to-Integral Power Kit

Upgrades power assist steering to integral power steering. Eliminates the power cylinder and control valve, and replaces the manual steering box with an integral power steering box. Kit includes integral power steering box, rag joint, hose kit, and drag link adapter.

'70 - '77	289, 302, 351W.	6671FARKTPS8	kit	950.00
-----------	-----------------	--------------	-----	--------

Rear Suspension Components

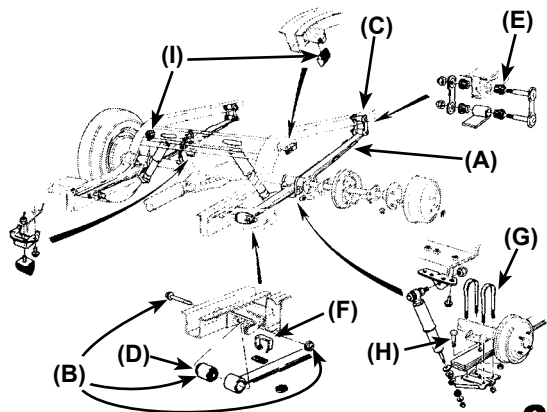

REAR LEAF SPRINGS (A)

Made in the USA. Please specify year, model, engine size, with or without A/C, and number of leaves when ordering.

NOTE: These are oversized items. Additional shipping charges apply.

'70 - '77	starts at	299.95
-----------	-----------	--------

**OVER
SIZE**



FRONT OF REAR LEAF SPRING MOUNT KIT (B)

Includes bolt, bushing and nut. Requires 2 per vehicle.

'70 - '73	F53	kit	24.95
-----------	-----	-----	-------



FS772

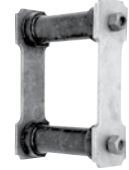

FS1008

REAR LEAF SPRING SHACKLE KITS (C)

Requires 2 kits per vehicle.

'70 - '73	FS772	kit	39.95	
'74 - '77	4" center to center. Includes 4 bushings and 2 nuts.	FS1008	kit	49.95
'75 - '77	3 ¹ / ₂ " center to center.	FS772	kit	39.95



RB82



HB1059

REAR SPRING BUSHINGS

Front of Spring (D)

Requires 2 per vehicle.

'70 - '77	RB82	ea	16.95
-----------	------	----	-------

Rear of Spring (E)

Requires 8 per vehicle.

'70 - '77	HB1059	ea	3.95
-----------	--------	----	------



REAR LEAF SPRING BAND CLAMP SET (F)

Includes 2 short bands, 2 medium bands, 2 long bands and 6 rubber insulators. Used with 2¹/₂" wide spring with 4 leaves.

'71 - '72	C4DZ-5724A	ea	24.95
-----------	------------	----	-------



C6DZ-5705A



D5DZ-5705A

REAR SPRING U-BOLTS (G)

Requires 4 per vehicle.

'70 - '74	'70 - '74 Maverick; '71 - '72 Comet. 7/16" × 3 ¹ / ₄ " × 6". Includes 2 nuts and 2 washers.	C6DZ-5705A	ea	8.95
'75 - '77	7/16" × 2 ¹ / ₂ " × 6 ¹ / ₈ ". Includes 2 nuts.	D5DZ-5705A	ea	8.95



REAR LEAF SPRING CENTER BOLTS (H)

Correct center bolts that hold together the leaves of the rear leaf springs. 5/16" - 24 × 1.39", .5" O.D. Package of 2. Requires 1 package per vehicle.

	378683S	pr	8.95
--	---------	----	------



REAR AXLE BUMPER (I)

Requires 2 per vehicle.

'70 - '74	Maverick; '71 - '73 Comet.	C6AZ-4730A	ea	8.95
-----------	----------------------------	------------	----	------

NEW



2502499 D0AZ-2365A 600706

BRAKE BOOSTER CHECK VALVES AND GROMMET

Check Valves

'70 - '77	2 prong.....	2502499.....	ea	9.95
'75 - '77	Bendix booster.....	D0AZ-2365A.....	ea	8.95

Grommet

'70 - '77	600706.....	ea	2.50
-----------	-------	-------------	----	------



**BRAKE BOOSTER
PUSH ROD-TO-FIREWALL BOOT**

'70 - '71	RP32AA.....	ea	9.95
-----------	-------	-------------	----	------

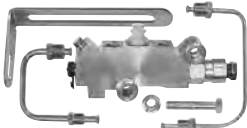

VL3350KF



VL3359KN

PROPORTIONING VALVE KITS

Features a fluid metering pressure failure indicator as well as a pressure proportioning function. Kits include valve, bracket, lines, and fittings. These are universal kits that can be used as replacements.

'70 - '77	With disc / drum brakes.	VL3350KF.....	kit	144.95
	With disc / disc brakes.	VL3359KN.....	kit	169.95



DISC BRAKE PROPORTIONING VALVE

Adjustable replacement; not like OEM. Requires modified brake lines.

'70 - '77	With front disc brakes.	A0707.....	ea	59.95
-----------	-------------------------	-------	------------	----	-------



BRAKE DISTRIBUTION VALVE

NOTE: May not be an exact replacement. May require bending or replacement of brake lines.

Drum / drum brakes with dual-reservoir master cylinder... C7ZZ-2B257A.....ea 89.95



C8AZ-2B264A



D5AZ-2B264A

**BRAKE PRESSURE DIFFERENTIAL VALVE
WARNING LAMP SWITCHES**

'70	Before 7/14/69.....	C8AZ-2B264A.....	ea	34.95	
'73 - '77	Maverick; '75 - '77 Comet.	D5AZ-2B264A.....	ea	34.95



**MASTER CYLINDER
PUSH ROD BOOT**

'70 - '73	With drum brakes.	OA-2180.....	ea	6.95
-----------	-------------------	-------	--------------	----	------



MASTER CYLINDER PUSH ROD BUSHING

'71 - '73	C9AZ-2474A.....	ea	5.95
-----------	-------	-----------------	----	------



MC39495



MC36440



D6FZ-2140C

MASTER CYLINDERS - NEW

'70 - '73	'70 - '73 Maverick all; '71 - '73 Comet without power brakes. Dual reservoir.	MC39495.....	ea	74.95
'74 - '77	1 5/16" bore. With manual front drum or manual front disc brakes.	MC36440.....	ea	69.95
	With power front disc brakes.	D6FZ-2140C.....	ea	49.95



C7AZ-2162A
D3AZ-2162A

MASTER CYLINDER CAPS

'70 - '73	With drum brakes before 1/15/73. Chrome. Includes gasket.	C7AZ-2162A.....	ea	22.95
'70 - '73	With manual drum brakes before 1/15/73. Cadmium.	D3AZ-2162A.....	ea	19.95



42068



42069

MASTER CYLINDER CAP GASKETS

'70 - '73	Before 1/15/73.	42068.....	ea	9.95
'74 - '77	42069.....	ea	6.95	

BRAKE HOSES - RUBBER



C7OZ-2078A

SP4959

Front Drum

'71 - '73	C7OZ-2078A.....	ea	19.95
'74 - '75	SP5290.....	ea	19.95

Front Disc

'74 - '77	All.....	SP4959.....	ea	19.95
-----------	----------	-------------	----	-------



D0DZ-2282C



D0DZ-2282B

Rear Drum

'70	With 9" brakes.....	D0DZ-2282C.....	ea	34.95	
'71 - '72	6-cylinder with 9" brakes.	D0DZ-2282C.....	ea	34.95
'71 - '74	250 / 302 with 10" brakes.	D0DZ-2282B.....	ea	39.95



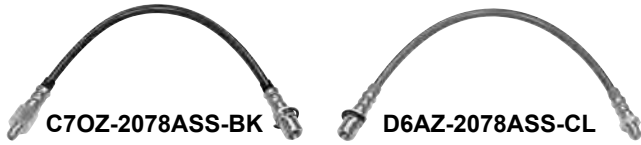

BRAKE HOSES – BRAIDED STAINLESS STEEL

Front Drum

'71 – '73	Black jacket	C7OZ-2078ASS-BK	ea	34.95
	Clear jacket	C7OZ-2078ASS-CL	ea	34.95
'74 – '75	Black jacket	D4DZ-2078ASS-BK	ea	34.95
	Clear jacket	D4DZ-2078ASS-CL	ea	34.95

Front Disc

'74 – '77	Black jacket	D6AZ-2078ASS-BK	ea	32.95
	Clear jacket	D6AZ-2078ASS-CL	ea	32.95

Rear Drum

'70	With 9" brakes.			
	Black jacket	D0DZ-2282CSS-BK	ea	42.95
	Clear jacket	D0DZ-2282CSS-CL	ea	42.95
'71 – '72	6-cylinder with 9" brakes.			
	Black jacket			
	D0DZ-2282CSS-BK	ea	42.95
	Clear jacket			
	D0DZ-2282CSS-CL	ea	42.95
'71 – '74	250 / 302 with 10" brakes.			
	Black jacket			
	D0DZ-2282BSS-BK	ea	49.95
	Clear jacket			
	D0DZ-2282BSS-CL	ea	49.95



BRAKE HOSE CLIP SET

Set of 3.				
'70 – '77	BHC101	set	5.95

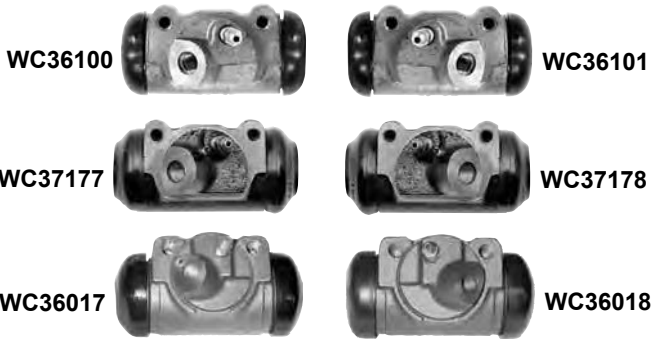

WHEEL CYLINDERS

Front – Drum

'70	1 1/16" bore.			
	LH.....	WC36100	ea	29.95
	RH.....	WC36101	ea	29.95
'71	Maverick 170, 200, 250, 302; Comet 6-cylinder except 250.			
	1 1/8" bore.			
	LH.			
	WC37177	ea	29.95
	RH.			
	WC37178	ea	29.95
'71	Comet 250, 302.			
	1 1/8" bore.			
	LH.			
	WC36017	ea	29.95
	RH.			
	WC36018	ea	29.95

WHEEL CYLINDERS CONTINUED

Front – Drum Continued

'72	6-cylinder except 250.			
	1 1/8" bore.			
	LH.			
	WC37177	ea	29.95
	RH.			
	WC37178	ea	29.95
'72	250, 302.			
	1 1/8" bore.			
	LH.			
	WC36017	ea	29.95
	RH.			
	WC36018	ea	29.95
'73 – '75	1 1/8" bore.			
	LH.			
	WC36017	ea	29.95
	RH.			
	WC36018	ea	29.95

WC17507



WC17508



Front – Disc

'74 – '75	7/8" bore.			
	LH.			
	WC17507	ea	14.95
	RH.			
	WC17508	ea	14.95



WC37108

Rear – Drum

'70	27/32" bore.			
	LH or RH	WC37108	ea	19.95
'71	170, 200.			
	27/32" bore.			
	LH or RH	WC37108	ea	19.95
'72	27/32" bore.			
	LH or RH	WC37108	ea	19.95
'74 – '75	7/8" bore.			
	LH.			
	WC17507	ea	14.95
	RH.			
	WC17508	ea	14.95



BD1634



BD2641



BD2623

BRAKE DRUMS

Front

'70 – '73	6-cylinder.			
	9". 4 lug holes.....	BD2642	ea	49.95
'70 – '73	All with finned drum, full cast drum.			
	10" x 2 1/4" or 10" x 2 1/2". 5 lug holes.			
	BD1634	ea	54.95

Rear

'70 – '73	9" x 1 1/2". 2.434" center hole. 4 lug holes.			
	BD2641	ea	39.95
	10" x 1 3/4". 2.434" center hole. 5 lug holes.			
	BD2623	ea	39.95



NEW BRAKE SHOES

Requires 1 set per vehicle.

NOTE: Please be sure of your brake size before placing your order.

Front

- '71 250, 8-cylinder with 10" x 2 1/4".
Use with Brake Self-adjuster Repair Kits #QA2514 and #QA2515 (see below).
☛ QA154.....set.....29.95
- '72 250, 302 with 10" x 2 1/2".
Use with Brake Self-adjuster Repair Kits #QA2514 and #QA2515 (see below).
☛ QA169.....set.....34.95
- '73 - '75 10" x 2 1/2".
Use with Brake Self-adjuster Repair Kits #QA2514 and #QA2515 (see below).
☛ QA169.....set.....34.95

Rear

- '71 10" x 1 3/4".....QA151.....set.....29.95
- '73 - '77 10" x 1 3/4".....QA151.....set.....29.95

REMANUFACTURED BRAKE SHOES

Front

- '70 - '72 '70 - '72 Maverick with 9" x 2 1/4"; '71 - '72 Maverick / Comet 6-cylinder except 250 with 9" x 2 1/4".
☛ QA243.....set.....34.95

Rear

- '70 - '72 '70 Maverick all; '71 - '72 Maverick / Comet 6-cylinder except 250.
9" x 2 1/4".
☛ QA244.....set.....29.95



BRAKE DRUM HARDWARE KIT

Includes springs and hold-down kit.

- '71 Comet front with 10" x 2 1/4" brakes and rear with 10" x 2" shoes. Requires 2 per vehicle.
☛ H7045.....kit.....14.95



BRAKE SELF-ADJUSTER REPAIR KITS

Each kit includes screw assembly, lever spring, cable and rubber plug. Each kit does 1 wheel.

- '71 - '75 With 10" shoes. Front or rear.
LH.
☛ QA2514.....kit.....16.95
- RH.
☛ QA2515.....kit.....14.95



DRUM BRAKE ADJUSTMENT HOLE COVERS

Oval plugs. 5/16" x 1". Set of 4.

- '70 - '77 '70 - '72 front drums; '70 - '77 rear drums.
☛ AK108.....set.....2.00



DISC BRAKE ROTOR

- '74 - '77 D6042.....ea.....59.95



184070

184069

REMANUFACTURED DISC BRAKE CALIPERS

All units sold on an exchange basis only. Call for information.

- '74 - '77 LH.
☛ 184070.....ea.....29.95
- RH.
☛ 184069.....ea.....29.95
- Core fee for either.....ea.....25.00



FRONT DISC BRAKE PADS

- '74 - '77 D91.....set.....27.95



639540

BRAKE SPEED BLEEDERS

Replaces the original bleeder screw to make bleeding brakes a one-person task. Uses OEM-style sealing area to guarantee a positive leak-proof seal.

- '70 - '75 Front and rear brake drums.
1/4" - 28 thread x 1" long.
639540.....pr.....17.95
- '70 - '77 '70 - '75 Maverick front disc brakes, front / rear drum brakes; '76 - '77 Maverick front disc brakes, rear drum brakes.
3/8" - 24 thread x 1" long.
639590.....pr.....19.95

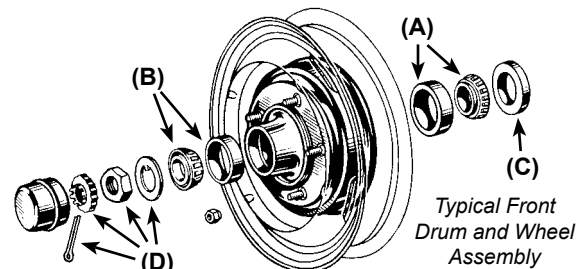

Typical Front Drum and Wheel Assembly



WHEEL BEARINGS AND RACE ASSEMBLIES

Inner - Front (A)

- '70 Before 8/25/69.....A-6.....ea.....12.95
- '70 - '77 After 8/25/69.
☛ A-13.....ea.....12.95

Outer - Front (B)

- '70 Before 8/25/69.....A-2.....ea.....12.95



WHEEL BEARINGS AND RACE ASSEMBLIES CONTINUED

Outer – Front Continued

'70 – '77 After 8/25/69.
 ⚙️ A-12ea 10.95

Outer – Rear

'70 – '77 With 7.75", 8", 9" (28 spline) or 9" (31 spline) ring gear.
 Requires 2 per vehicle.
 ⚙️ RW207CCRA.....ea 32.95



INNER WHEEL BEARING SEAL (C)

SEE DIAGRAM ON PREVIOUS PAGE
 '70 – '77 ⚙️ 6815ea 4.95

REAR WHEEL SEAL (AXLE SEAL)

'70 – '77 With 7.75", 8", 9" (28 spline) or 9" (31 spline) ring gear.
 Requires 2 per vehicle.
 ⚙️ 9569Sea 11.95

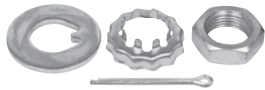

FRONT SPINDLE LOCK NUT KIT (D)

SEE DIAGRAM ON PREVIOUS PAGE
 This universal kit includes (1) 3/4" – 16 nut;
 (1) washer; (1) retainer; (1) cotter pin. This kit will work with most of the
 applications above but check your spindle thread size before ordering.
 '70 Maverick before 8/24/69.
 04990kit 6.95



REAR BRAKE PLATE MOUNTING BOLTS

Holds the backing plate to the rear axle housing. Set of 4 bolts. Requires 2 sets per vehicle. 3/8" – 24 x 1 3/16" bolt, .62" x 1.0" head.



With 8" or 9" rear end.
 ⚙️ 375748Sset 5.95

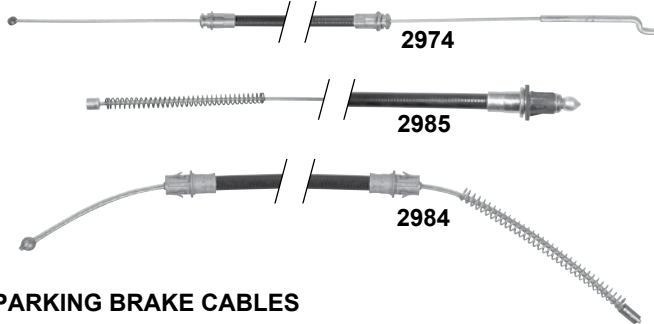

PARKING BRAKE CABLES

Drum – Front
 '73 – '74 All 2974ea 79.95

Drum – Rear
 '71 – '74 LH.
 ⚙️ 2985ea 39.95
 RH.
 ⚙️ 2984ea 39.95

PARKING BRAKE CABLES CONTINUED

Drum – Rear Continued

'75 – '77 LH 3107ea 44.95
 RH no longer available.

Disc – Front

'73 – '74 All 2974ea 79.95

Disc – Rear

'74 LH 2985ea 39.95
 RH 2984ea 39.95
 '75 – '77 LH 3107ea 44.95
 RH no longer available.



PARKING BRAKE CABLE RETAINER SET

Holds the cable to the bracket, crossmember, etc.
 Set of 3 clips. Not all clips are used with some applications.

'70 – '77 ⚙️ AK1030set 4.95



PARKING BRAKE CABLE CONNECTOR

'70 – '74 Maverick; '72 Comet.
 ⚙️ C6OZ-2A790Aea 10.95



C7ZZ-2A808A



ST2A816

PARKING BRAKE REAR CABLE IDLER

'70 – '74 ⚙️ C7ZZ-2A808Aea 11.95

PARKING BRAKE REAR CABLE IDLER BRACKET

Welds to the front floor pan.
 '70 – '74 ⚙️ ST2A816ea 9.95

Typical Parking Brake Cable Assembly

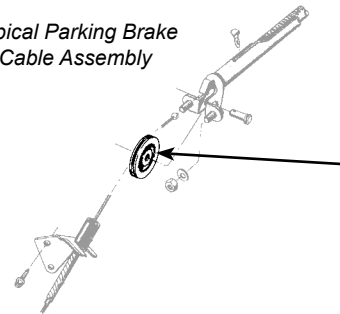

OM-2804

PARKING BRAKE CABLE PULLEY

'71 – '75 Maverick; '71 – '72 Comet.
 ⚙️ OM-2804ea 24.95



PARKING BRAKE CABLE EQUALIZER ROD

7 1/2" long. Includes 2 nuts.
 '71 – '77 ⚙️ B7A-2628Bea 15.95



C1DD-2A642R



D1OZ-2A642R

PARKING BRAKE LEVER LINKS

This is the link between the parking brake lever and the primary brake shoe. 6" long.

'70 – '72 6-cylinder with 9" rear drum brakes. Requires 2 per vehicle.
 ⚙️ C1DD-2A642Rea 7.95
 '71 – '75 250 / 302 with 10" rear drum brakes. Requires 2 per vehicle.
 ⚙️ D1OZ-2A642Rea 7.95

NEW

BRAKE



PARKING BRAKE LINK SPRING RETAINER
 '72 - '77 Maverick 250 / 302 with 10" brakes; '72 - '74 Comet 250 / 302 with 10" brakes; '74 - '75 Comet with 11" brakes.
 ☞..... C4UZ-2A787Bea 3.95



PARKING BRAKE PEDAL PAD AND TRIM

Pad			
'75 C8SZ-2454Bea 3.95
Trim			
'75 C8SZ-2A798Aea 9.95

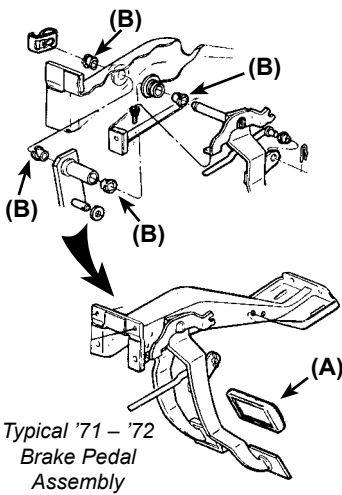

BRAKE PEDAL PADS AND TRIM (A)

Pads			
'70	M/T C5ZZ-2457Gea 3.95
'71	Maverick; Comet with drum brakes. M/T. ☞ C5ZZ-2457Gea 3.95
	A/T. ☞ C6OZ-2457Aea 6.95
'72	M/T. ☞ C5ZZ-2457Gea 3.95
	A/T after 4/3/72. ☞ C6OZ-2457Aea 6.95
'73 - '75	With drum brakes. M/T C5ZZ-2457Gea 3.95
	A/T C6OZ-2457Aea 6.95
'74 - '75	With disc brakes before 12/16/74. M/T C5ZZ-2454Dea 9.95
	A/T D3ZZ-2454Aea 9.95
'75	With disc brakes after 12/16/74. M/T C5ZZ-2457Gea 3.95
	A/T C6OZ-2457Aea 6.95
'76 - '77	M/T C5ZZ-2457Gea 3.95
	A/T C6OZ-2457Aea 6.95



Pad Trim			
'72 - '77	M/T D1ZZ-2A487Bea 14.95
	A/T after 4/3/72 C6OZ-2A487Aea 13.95



BRAKE PEDAL PAD AND TRIM
 Includes brake pedal pad with "DISC BRAKE" emblem in the middle and outer trim piece.

For individual parts, see numbers D3ZZ-2454A and C6OZ-2A487A in previous column.

'74 - '75	A/T with disc brake before 12/16/74. D3ZZ-2454/2A487Aea 19.95
-----------	--	---------	-------------



BRAKE PEDAL ARM MOUNT BRACKET BUSHING (B)
 Requires 2 per arm.
 '70 - '77
 ☞ B7AZ-2471Bea 1.95



BRAKE LAMP (STOP LAMP) SWITCH
 '70 - '77
 ☞ SW881ea 15.95



REAR DRUM BRAKE 11" UPGRADE KIT
 Convert your small rear drum brakes to big 11" brakes with heavy-duty finned drums. Fully assembled and ready to bolt on. Features high-performance ceramic brake shoes, high-volume wheel cylinders, pre-assembled on new backing plates. Limited 1-year manufacturer's warranty.

With drum brakes and 8" or 9" Ford small bearing (3 3/8" x 2") rear end DR1504Kkit 559.00



FRONT DRUM-TO-DISC BRAKE CONVERSION KIT OVER SIZE
 Convert your front drum brakes to disc brakes. This front manual disc brake kit bolts to your original spindles. Kit includes:

- dual-reservoir master cylinder
- OE-style cast-iron 4-piston calipers
- pads
- caliper brackets
- rotors
- hoses
- proportioning valve
- bearings
- seals
- dust caps
- hardware

NOTE: 14" or larger disc brake wheels required. Not all 14" wheels will fit this application. Wheel fitment is customer's responsibility.

Limited 1-year manufacturer's warranty.

NOTE: This is an oversized item; additional shipping charges apply.

'71 - '77	With factory drum brakes and 5-lug, 8-cylinder spindles. ☞ DB1521MNSkit 889.00
-----------	---	----------	--------------



Typical Rear Brake Kit

REAR DRUM-TO-DISC BRAKE CONVERSION KITS OVER SIZE
 Includes single-piston cast-iron calipers with built-in parking brake and 10.5" x .9375" rotors.

NOTE: These are oversized items; additional shipping charges apply.
 8" or 9" 28-spline rear end with small bearing. Minimum 14" wheel.

..... A111-2kit 799.00
--------------	----------	--------------

9" 31-spline rear end with large bearing. Minimum 14" wheel.

..... A110-2kit 799.00
--------------	----------	--------------

NOTE: The A111-2 is to be used with all 14" wheels including the Styled Steel and Magnum 500s.



TAILLIGHT, TRUNK, INTERIOR LAMP WIRE LOOM CLIP NEW
 Fits various Ford and Mercury vehicles. Black plastic clip that fastens onto sheet metal and hooks around wire.
 ⚙️ 643558 ea 1.30



UNIVERSAL TAPE-ON WIRE LOOM ANCHOR CLIP NEW
 Fits all Ford and Mercury vehicles. Tapes onto the wire loom and then fastens to sheet metal (fender apron, etc.)
 ⚙️ 642553 ea 1.30



SPIN LOCK NUTS
 1/4" - 20.
 Standard flange (1 9/32" O.D.) AV14874 ea 25
 Large flange (1 1/16" O.D.) AV2769 ea 30

Interior Hardware



INTERIOR SCREW KITS
 Kit consists of all the screws that are visible inside the passenger compartment. Kits usually contain screws for the following: coat hooks, sunvisors, dash bezel, dash panel, radio bezel, door weatherstrip, quarter seals, kick panels, pillar moulding, radio speaker, quarter panels, step plates, seat side, and steering column cover. May contain more screws than needed.

270442
 '70 - '72 2-door.
 46 pieces FO1600 kit 15.95
 '74 - '75 2-door.
 42 pieces.
 ⚙️ 270442 kit 15.95
 '74 - '75 4-door.
 63 pieces FO1786 kit 24.95



C6AZ-6224146B **AK236** **AK273**
ARM REST CLIPS AND SCREWS
Clips
 '70 - '77 '70 - '72 Maverick; '73 - '77 Maverick without molded arm rest;
 '71 - '72 Comet without molded arm rest.
 ⚙️ C6AZ-6224146B ea 4.95

Screws
 Set of 2.
 '70 - '77 Hex washer head.
 ⚙️ AK236 pr 1.00
 Phillips pan head.
 ⚙️ AK273 pr 1.00



STEP PLATE SCREW
 '70 - '77 '70 requires 8, '71 - '77 requires 12.
 AV1717 ea 30



DOOR LATCH SCREWS
 Set of 3 screws.
 '70 - '72 ⚙️ AK400 set 2.50



DOOR HINGE PIN
 '70 - '77 Requires 1 per hinge. Requires trimming.
 ⚙️ AV14559 ea 1.95



DOOR HINGE PIN BUSHING
 '70 - '77 Requires 2 per hinge.
 ⚙️ AV14550 ea 1.25



DOOR LOCK CYLINDER RETAINER
 '70 - '77 Maverick; '71 - '72 Comet.
 ⚙️ C5AZ-6222023A ea 2.00



DOOR STRIKER PLATE SCREWS
 Set of 4.
 '70 - '77 Zinc plated.
 ⚙️ AK560 set 3.00
 Stainless steel.
 ⚙️ AK562 set 3.00



COAT HOOK SCREW
 '70 - '77 ⚙️ AV2713 ea 25

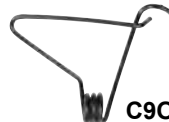

ACCELERATOR PEDAL HARDWARE
Spring
 '70 - '71 '70 Maverick 6-cylinder before 6/16/69; '71 Comet all.
 ⚙️ C9OZ-9760A ea 7.95

Pin
 '70 - '71 '70 Maverick 6-cylinder; '71 Comet all.
 ⚙️ C8OZ-9873A ea 4.95



FIREWALL INSULATION RETAINER
 Rubber.
 '70 - '72
 ⚙️ C8ZZ-6501691A ea 1.95



HEATER BOX CLIP
 Holds the heater box that houses the heater core. Quantity varies by vehicle.
 '70 - '77 Maverick; '71 - '72 Comet.
 ⚙️ C0DF-19A779A ea 2.95



STEERING WHEEL MOUNTING NUT NEW
 Correct style lock nut for mounting the wheel to the column shaft. 5/8" - 18. 1 5/16" hex. Grade 5, cadmium plated.
 '70 - '77
 ⚙️ 382412-S ea 4.95

Trunk / Exterior Hardware



SPARE TIRE MOUNTING NUT

'70 - '77 C8AZ-1462B ea 4.95



WINDSHIELD WIPER ARM CLIP

Genuine Ford.

'70 - '77 C5ZZ-17531A ea 2.95



C6AZ-13031R



D5UZ-13031A

HEADLAMP SPRINGS

'70 C6AZ-13031R ea 6.95

'75 - '77 Genuine Ford. D5UZ-13031A ea 8.95



HEADLAMP ADJUST KIT

Includes 2 adjusting screws and nuts, 4 attaching screws and 1 spring. Enough to do 1 headlamp.

'70 - '74 Maverick; '73 - '74 Comet. AK413 kit 7.95



AK1011



AK1012

HEADLAMP ADJUSTMENT BUCKET BEARING KITS

Small nylon pin that mounts in the fender behind the headlamp adjustment bucket. Set of 6 pins.

'71 - '77 '71 - '73 Maverick; '71 - '77 Comet. Requires 3 pins per side. AK1011 set 1.50

'74 Maverick. Requires 3 pins per side. AK1012 set 1.50



HEADLAMP DOOR MOUNTING KIT

Includes 6 stainless steel screws and 6 nylon nuts.

'70 - '77 AK1014 kit 4.00

EXTERIOR SCREW KITS

Kits include screws for headlamp moulding, exterior (side-view) mirror, license plate lamp mounting, and license plate lamp lens.

'75 11 pieces FO1785 kit 4.95

'75 Also includes screws for wheelhouse moulding. 39 pieces FO1785A kit 12.95

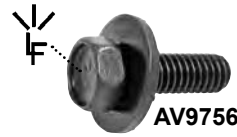

AV9756

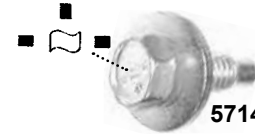

57140-S8

BODY BOLTS

'70 $\frac{5}{16}$ " - 18 x 1". Has "LF" stamped on top. Requires 12. AV9756 ea 40

$\frac{5}{16}$ " - 18 x $\frac{15}{16}$ ". With flat washer. Has flag stamped on top. Zinc plated 57140-S8 ea 1.50



AK433C



AK341B



AV10823

FENDER BOLTS

'70 - '77 Requires 12. $\frac{5}{16}$ " - 18 x $\frac{15}{16}$ ". With star washer. Has "HTS" logo on top. Cadmium AK433C ea 1.50

'70 - '77 Requires 12. $\frac{5}{16}$ " - 18 x 1". With star washer. Has "01IG" stamped on top. Black AK341B ea 1.00

'70 - '77 $\frac{7}{8}$ ". With flat washer. Has flag stamped on top. Zinc plated. 57140-S8 ea 1.50

'70 - '77 $\frac{1}{4}$ " - 20 x $\frac{7}{8}$ ". With disc washer (washer O.D.: $\frac{3}{4}$ "). $\frac{7}{16}$ " hex). Has "LF" stamped on top. Parkerized. Use with U-nut #AV10050 and #AV10051 below. AV10823 ea50



AV10050



AV10051



AV8814

FENDER MOUNT U-NUTS

'70 - '77 $\frac{1}{4}$ " - 24. $\frac{1}{32}$ " center of hole to edge. Use with body bolt #AV10823. AV10050 ea50

$\frac{25}{32}$ " center of hole to edge. Use with body bolt #AV10823. AV10051 ea60

'70 - '77 $\frac{5}{16}$ " - 18. Long reach. Requires approximately 10 per vehicle. AV8814 ea50

Set of 12 AK119 set 5.00



378362S



AV11293



AV8405

TUBE NUTS (BARREL CLIPS)

Used to attach to your vehicle emblems that have pins on the back. They are not necessary for self-adhesive emblems.

Small ($\frac{1}{16}$ " stud for $\frac{1}{8}$ " panel hole). 378362S ea50

Medium ($\frac{1}{8}$ " stud) AV11293 ea50

Large ($\frac{3}{16}$ " stud for $\frac{1}{4}$ " panel hole). AV8405 ea 1.00



FO193

BUMPER BOLT KITS

Each kit does both front and rear bumpers.

'70 - '71 20 pieces FO193 kit 22.95

'74 - '77 40 pieces FO196 kit 32.95



HOOD MOULDING SCREWS

Zinc plated. 6 pieces.

'70 - '77 Maverick..... AK2001set..... 1.50

'73 - '77 Windshield

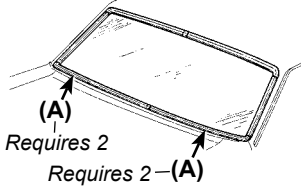

'73 - '77 4-door Back Glass

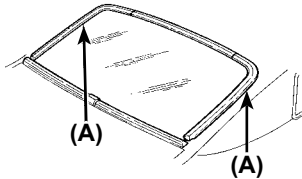

AV10625



D1AZ-6542413B



D0DZ-6203174A

WINDSHIELD AND BACK GLASS MOULDING RETAINERS

'70 - '72 Yellow..... AV10625ea35

'70 - '77 '73 - '77 windshield moulding requires 4 (2- or 4-door); '73 - '77 back glass moulding requires 2 (4-door only).
Brown.

(A)..... D1AZ-6542413Bea 30

Set of 12..... AK247set..... 3.00

'73 - '77 Blue..... D0DZ-6203174A.....ea 40



UNIVERSAL ROCKER PANEL MOULDING CLIPS

3/4" x 3 3/16" plate, 1/2" stud. Butterfly style. Includes nut and rubber washer.

..... 3164ea 2.50

Set of 12..... 3164SETset..... 26.95

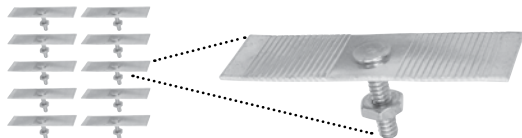

AK1008

UNIVERSAL BODY MOULDING CLIP SET

Snaps off to fit almost any body moulding. 24 x 3/4" stud. Package of 10.

..... AK1008pkg..... 9.95



UNIVERSAL MOULDING CLIP - NYLON

Nylon clip with a push-pin for a 5/16" hole. The clip can be snapped off at 5/32" perforations to fit the moulding. The clip plate is 3" long and 3/4" wide. On some mouldings the clip may need to be installed in the moulding and then pushed onto the vehicle.

.....AK8581ea 2.00

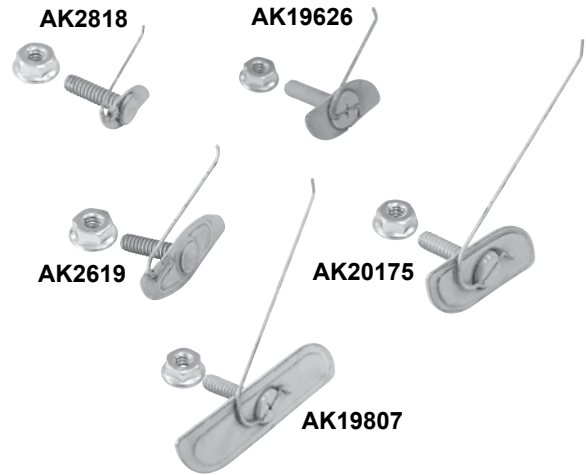

UNIVERSAL MOULDING CLIPS AND NUTS

Thread size: 10 - 24.

3/8" x 1 3/16" plate, 5/8" long stud.... AK2818ea 1.50

1/2" x 1 1/16" plate, 3/4" long stud AK19626ea 1.50

9/16" x 1 1/2" plate, 3/4" long stud AK2619ea 1.50

1 1/16" x 1 5/8" plate, 3/4" long stud... AK20175ea 2.00

1 1/16" x 2 17/32" plate, 3/4" long stud. AK19807ea 2.00



WHEELHOUSE MOULDING SCREW KIT

Requires 1 kit per wheelhouse, 4 kits per vehicle. 8 pieces.

'70 - '77 With wheelhouse moulding.

..... AK588kit..... 1.75

STUD FOR WINDSHIELD AND TRIM MOULDING CLIPS

This zinc-plated steel screw-in stud is to replace broken weld-on studs used for attaching moulding clips to body. Short length for shallow areas with Phillips flat head.

With weld-on studs for windshield or trim moulding clips.

..... AK1017ea35



AV14231

D6AZ-1107A

WHEEL STUD BOLTS

1/2" - 20 x 1 9/16".

'70 - '77 Grade 8. Press-in.

..... AV14231ea 1.95

'76 Rear D6AZ-1107Aea 1.00

Engine Hardware

UNDERHOOD AND TRUNK HARDWARE KIT

Includes all the bolts, nuts, u-nuts and screws under the hood and in the trunk, such as fender bolts and battery tray bolts and nuts, not including engine and A-frame hardware. This kit is specific to '74 - '75, but most items will work on other years. 190 pieces.

'74 - '75 FO275kit..... 109.95



Typical Kit

COMPLETE ENGINE HARDWARE KIT **AMK PRODUCTS**

Exact original equipment fasteners. Manufactured in the USA. All fasteners are of the correct grade and finish as specified by all Ford engineers. All original manufacturer markings and design details.

A typical kit contains fasteners for air cleaner, carburetor, crank pulley, distributor, engine tag, exhaust manifolds, fuel pump, heat shroud, ignition coil, intake manifold, oil filter adapter, oil pan, timing cover, valve covers, water neck, and water pump. Actual contents may vary.

'70 - '73 250 C9DE-342kit..... 79.95



Typical Kit

AIR CONDITIONING FASTENER KIT **AMK PRODUCTS**

A typical kit includes fasteners to attach brush and holder assembly, compressor, compressor bracket, compressor clutch, compressor braces and idler pulleys. 20 pieces.

'70 - '73 200 / 250.D0ZA-AC200/250kit..... 24.95



AK301



HC209

RADIATOR HOSE CLAMPS

Wire-type hose clamps.

1 3/4" AK300ea 8.00
2" AK301ea 8.00

HEATER HOSE CLAMP

Original style tower clamp.

'70 - '77 HC209ea 2.50



DISTRIBUTOR HOLD-DOWN CLAMP

Chrome. Includes installation bolt.

V6, V8 except FE.

.....M12270A302ea 10.95



ALTERNATOR PULLEY NUT AND WASHER **AMK PRODUCTS**

Gold zinc.

'70 - '77 C7AL-644ea 2.95



CP5185



MG5185

ALTERNATOR BRACKET SETS

Includes adjustment arm and top bracket.

Includes adjustment arm and top bracket.

'70 - '77 Black. CP5185set..... 22.95
NEW Chrome. MG5185set..... 24.95



C5AZ-10718A



B10718BL



D0AZ-10756A



D0AZ-10756SS

BATTERY HOLD-DOWN HARDWARE

Clamps

'70 - '77 C5AZ-10718Aea 8.95
Billet aluminum. B10718BLea 39.95

J-bolts

'70 - '72 Requires 2. D0AZ-10756Aea 2.50
Stainless steel. D0AZ-10756SSpr 14.95



STARTER SOLENOID AND VOLTAGE REGULATOR MOUNTING SCREWS

Set of 4. AK266set..... 1.00



376914S

WIRING STRAPS

'70 - '77 376914Sea70
Set of 20. AK114Bset..... 8.00



SOLDERLESS WIRE TERMINAL / CONNECTOR KIT

Contains an assortment of the 18 most popular solderless, insulated terminals and connectors. Comes in a plastic display box with dividers. Includes 9" crimping tool. 175 pieces. TK50413Akit..... 19.95



AK225



4210



4209

M9697A



AK241

AIR CLEANER WING NUTS AND THUMBSCREW

Wing Nuts - Replacement

'70 - '77 V8. AK225ea 1.25

Wing Nuts - Aftermarket

Spectre

Will fit any 1/4" - 20 thread studs. This triple-chrome plated tri-corner design wing nut features a black wrinkle finish in the center.

Small 4210ea 4.95
Large 4209ea 6.95

Ford Oval

Chrome oval with dark blue center. Will fit 1/4" - 20 thread stud.

..... M9697Aea 14.95

Thumb screw

'70 - '77 6-cylinder. AK241ea 2.50



FUEL SENDER LOCKING RING

'70 - '77 C0AZ-9A307B ea 5.95



FAN SPACER BOLT KIT

Kit includes four 5/16" - 24 x 3 1/4" bolts and four lock washers.

With 2 3/4" fan spacer.

..... AK1040 kit 7.95



OIL PAN BOLT KIT

Zinc-plated, grade 5, hex flange-head bolts. Kit includes (6) 5/16" - 18 x 3/4" and (18) 1/4" - 20 x 1/2" bolts.

'71 - '77 302.

..... 6087 kit 15.95



AK1029



AK1039

VALVE COVER MOUNT KITS

Dress up your engine with this stainless steel valve cover mounting kit. Each kit contains (12) stainless steel 3/8" hex washer head bolts and (12) 1/4" internal tooth stainless steel lock washers.

NOTE: Steel kits are for use with steel valve covers only, and aluminum kit are for use with aluminum valve covers only.

Fits all small-block Windsor V8s.

With Steel Valve Covers

Contains 1/4" x 5/8" bolts.

..... AK1029 kit 9.95

With Aluminum Valve Covers

Contains 1/4" x 3/4" bolts.

..... AK1039 kit 9.95



VALVE COVER BOLTS

For fast removal of valve covers. Chrome ends feature Ford oval logo. Amount required varies with vehicle. Set of 4.

Fits all chrome V8 valve covers.

..... M6680A302 set 29.95



8913

LOCKING HEADER BOLTS

Double hex heads. 16 bolts per kit.

'70 - '77 Small-block. 3/8", 16 x 3/4".

..... 8913 kit 64.95

3/8", 16 x 1".

..... 8913A kit 74.95



UNDERDASH WIRING LOOM CLIP

Fits various Ford and Mercury vehicles. Attaches to firewall / fender apron and snap closes around loom.

..... 377986S ea 1.50



Transmission / Clutch Hardware



SHIFT LINKAGE REPAIR KIT

Kit includes 3 each of the following studs, nuts, washers, and pins.

'71 - '76

'71 - '73 Maverick 3 speed; '73 - '76 Maverick M/T with floor shift and '71 - '72 Comet M/T.

..... C5ZZ-7285RPK kit 22.95



FLYWHEEL BOLTS AND WASHERS

Includes 6 bolts and 6 washers. 7/16" - 20 x 1". Grade 8.

..... 912 set 12.95



FLEXPLATE BOLTS AND WASHERS

Includes 6 bolts and 6 washers. 7/16" - 20 x 1 3/16".

..... 6711 set 19.95



PRESSURE PLATE BOLTS AND WASHERS

Includes 6 bolts and 6 washers. 5/16" - 18 x 1". Grade 8.

'70 - '77 V8 911 set 13.95



U-JOINT REPAIR KIT - UNIVERSAL

This universal repair kit is for driveshaft u-joints with 1 1/8" O.D. bearings. Kit includes (1) 1 1/4" U-bolt; (2) 5/16" - 18 hex nuts; (2) 5/16" lock washers.

With driveshaft u-joints that have 1 1/8" O.D. bearings.

..... 81004 kit 4.95

Suspension / Steering Hardware



STRUT ROD NUT SET

For the under-body end of the strut rod. Includes two inner nuts (1 1/16" - 18 x 1 1/8", serrated) and two outer nuts (1 1/16" - 18 x 1").

'71 - '77

..... AK1031 set 14.95



PITMAN ARM-TO-STEERING GEAR NUT

Holds the pitman arm to the steering gear sector shaft. 7/8" - 14. 1 5/16" hex.

'70 - '77

With 1 1/8" sector shaft.

..... AK1032 ea 4.95



REAR LEAF SPRING BAND CLAMP SET

This set includes 2 short bands, 2 medium bands, 2 long bands and 6 rubber insulators. Used with 2½" wide spring with 4 leaves.

'71 Comet.
 C4DZ-5724A set 24.95



C6DZ-5705A

D5DZ-5705A

REAR SPRING U-BOLTS

Requires 4 per vehicle.

'70 - '74 '70 - '74 Maverick; '71 - '72 Comet.
 7/16" x 3¼" x 6". Includes 2 nuts and 2 washers.
 C6DZ-5705A ea 8.95

'75 - '77 7/16" x 2½" x 6½". Includes 2 nuts.
 D5DZ-5705A ea 8.95



REAR LEAF SPRING CENTER BOLTS

Correct center bolts that hold together the leaves of the rear leaf springs. 5/16" - 24 x 1.39", .5" O.D. Package of 2. Requires 1 package per vehicle.

..... 378683S pr 8.95



Brake Hardware



BRAKE HOSE CLIP SET

Set of 3.

'70 - '77 BHC101 set 5.95



QA2514

BRAKE SELF-ADJUSTER REPAIR KITS

Each kit includes screw assembly, lever spring, cable and rubber plug. Each kit does 1 wheel.

'71 - '75 With 10" shoes. Front or rear.
 LH.
 QA2514 kit 16.95

RH.
 QA2515 kit 14.95



H7045

BRAKE SHOE HARDWARE KIT

Includes springs and hold-down kit.

'71 Comet front with 10" x 2¼" brakes and rear with 10" x 2" shoes. Requires 2 per vehicle.
 H7045 kit 14.95



FRONT SPINDLE LOCK NUT KIT

This universal kit includes (1) ¾" - 16 nut; (1) washer; (1) retainer; (1) cotter pin. This kit will work with most of the applications above but check your spindle thread size before ordering.

'70 Maverick before 8/24/69.
 04990 kit 6.95



REAR BRAKE PLATE MOUNTING BOLTS

Holds the backing plate to the rear axle housing. Set of 4 bolts. Requires 2 sets per vehicle. ¾" - 24 x 1¾" bolt, .62" x 1.0" head.

With 8" or 9" rear end.

..... 375748S set 5.95



PARKING BRAKE CABLE RETAINER SET

Holds the cable to the bracket, crossmember, etc. Set of 3 clips. Not all clips are used with some applications.

'70 - '77 AK1030 set 4.95



PARKING BRAKE CABLE CONNECTOR

'70 - '74 Maverick; '72 Comet.

..... C6OZ-2A790A ea 10.95



Can't find the parts you're looking for?

TRY SEARCHING OUR WEB SITE!

New parts are added every week!

www.autokrafters.com

AIR CLEANER DECALS



- 200 Engine**
- '70 120 horsepower.DF941..... ea..... 5.50
 - '70 Has I.D. #D0ZF-9C611-D and is blue with white lettering.DF1297..... ea..... 5.00
 - '70 Has no I.D. number and is dark metallic blue with black lettering. Not as OEM.DF59..... ea..... 5.00
 - '71DF560..... ea..... 5.50
 - '72 - '73 1/VDF854..... ea..... 5.50



- 250 Engine**
- '70 - '73 250 cubic inches.DF172..... ea..... 5.50
 - 1/VDF1457..... ea..... 5.50
 - '74 - '75 1/VDF643..... ea..... 5.50



- 302 Engine**
- '70 - '71 2/V regular fuel.DF182..... ea..... 5.50
 - '70 - '71 4/V premium fuel.DF183..... ea..... 5.50
 - '72 - '73 2/V regular fuel.DF253..... ea..... 5.50
 - '72 - '73 4/V regular fuel.DF254..... ea..... 5.50
 - '73 After 1/1/73. 2/V regular fuel.DF584..... ea..... 5.50
 - '74 - '75 2/V regular fuel.DF480..... ea..... 5.50
 - '76 - '77 2/V unleaded fuel.DF716..... ea..... 5.50



- Autolite Replacement Parts**
- '70 - '72DF325..... ea..... 5.00



DF608

AFTERMARKET VALVE COVER DECALS

- Ford Powered by 302. DF607..... pr 6.00
- Ford Powered by 302 High-Performance.DF608..... pr 6.00
- Ford Powered by 302 Windsor.DF614..... pr 6.00

ENGINE COMPARTMENT DECALS



DF697

A/C Charge

- '71DF435..... ea..... 5.50
- '72 - '73DF551..... ea..... 5.00
- '74 - '77DF697..... ea..... 5.50

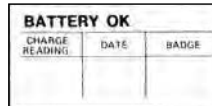

Battery Test OK

- '70 - '77DF194..... ea..... 4.50



DF224

Coil

- '70 - '72 Autolite®.DF224..... ea..... 5.50
- '72 - '77 Motorcraft®DF715..... ea..... 5.50



DF348

Voltage Regulator

- '70 - '72 YellowDF348..... ea..... 6.00
- '72 - '77DF714..... ea..... 5.50

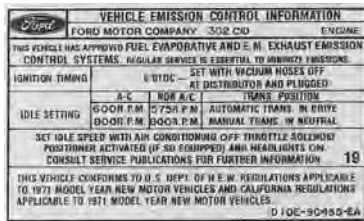

DF763

EMISSION DECALS

- '70 200 / 250. 10/1/69 through 1/1/70.DF772..... ea..... 5.50
- '70 302 2/V M/T after 1/1/70.DF311..... ea..... 5.50
- '71 200 M/T or A/T.DF666..... ea..... 5.50
- '71 302 2/V M/T or A/T.DF763..... ea..... 5.50
- '72 302 2/V M/T or A/T.DF843..... ea..... 5.50



DF641

EMISSION DECALS CONTINUED

- '73 302 2/V M/T or A/T after 1/1/73.DF641..... ea..... 5.50
- '76 M/TDF301..... ea..... 6.50
- '76 302 A/TDF302..... ea..... 6.50

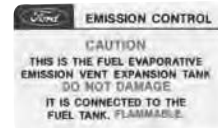

California Emission Decal

- '70DF954..... ea..... 5.50

INTERIOR DECALS



DF953

New Car Window Price Stickers

- Sold blank; customer must fill in information.
- '70DF953..... ea..... 5.50
 - '71DF1243..... ea..... 5.50
 - '75DF1215..... ea..... 5.50
 - '76DF1216..... ea..... 5.50
 - '77DF898..... ea..... 5.50



"Get It Together" Seat Belt Window Decal

Applied to the lower rear corner of front door windows.

- '75 - '77DF879..... ea..... 5.00



DF1508

Sunvisor Starting Instructions Sleeves

- '74DF1508..... ea..... 5.00
- '76DF1507..... ea..... 5.00

INTERIOR DECALS CONTINUED

THIS VEHICLE REQUIRES MAINTENANCE SCHEDULE "B" REFER TO YOUR OWNER'S MANUAL FOR INSTRUCTIONS

Glove Box Maintenance Schedule B
'76 - '77DF1287..... ea.....4.50

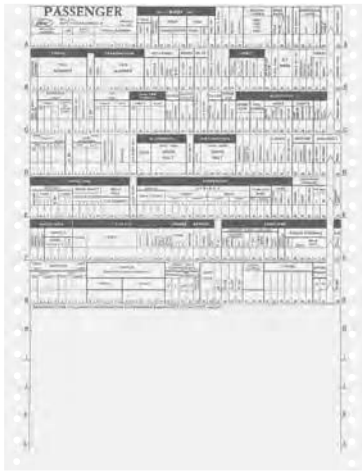

DF805

New Car Factory Build Sheets

Sold blank; customer must fill in information.
'71DF1381..... ea.....5.00
'72DF1214..... ea.....5.50
'74DF805..... ea.....5.50
'76DF894..... ea.....5.50
'77DF1167..... ea.....5.00

MAVERICK		RECOMMENDED TIRE SIZE and INFLATION PRESSURE (PSI)			
MODEL	YEAR	STANDARD TIRE	OPTIONAL TIRE	OPTIONAL TIRE	OPTIONAL TIRE
170	'70	6.00-13	24	26	6.45-14 24 26
					C75-14 24 26
FULL RATED MAXIMUM LOAD TO BE USED WITH THESE TIRES ONLY					
MODEL	YEAR	LOAD CAP.	LOAD CAP.	LOAD CAP.	LOAD CAP.
ALL	'70	700	4	2	2 100 lbs

DF1235

MAVERICK		RECOMMENDED TIRE SIZE and INFLATION PRESSURE (PSI)			
MODEL	YEAR	STANDARD TIRE	OPTIONAL TIRE	OPTIONAL TIRE	OPTIONAL TIRE
351	'70	6.45-14	24	26	6.45-14 24 26
351	'71	6.45-14	24	26	6.45-14 24 26
351	'72	6.45-14	24	26	6.45-14 24 26
351	'73	6.45-14	24	26	6.45-14 24 26
351	'74	6.45-14	24	26	6.45-14 24 26
351	'75	6.45-14	24	26	6.45-14 24 26
351	'76	6.45-14	24	26	6.45-14 24 26
351	'77	6.45-14	24	26	6.45-14 24 26
FULL RATED MAXIMUM LOAD TO BE USED WITH THESE TIRES ONLY					
MODEL	YEAR	LOAD CAP.	LOAD CAP.	LOAD CAP.	LOAD CAP.
3 OR 5 PASSENGERS	'70	700	4	2	2 100 lbs
4 OR 5 PASSENGERS	'71	700	4	2	2 100 lbs

DF949

Tire Pressure

Applied to the end of the RH front door above the latch mechanism or on the jamb below the striker plate.

'70 - '71 From late '70.
.....DF1235..... ea.....6.00
'72DF1245..... ea.....5.00
'73DF949..... ea.....6.00
'77DF1506..... ea.....5.00



Motorcraft® "Maintenance Performed" Door Jamb Decal
Used by Ford dealer when vehicle was serviced. Features Ford part number FPS-8375 printed at bottom and dated '88 with a Ford copyright date of 1966.
.....DF1000..... ea.....2.50

TRUNK DECALS

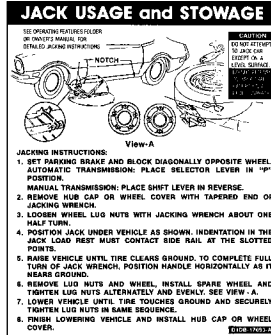

DF544

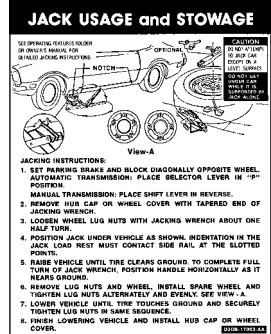

DF1213

Jack Instructions

'70DF943..... ea.....5.00
'71 - '72DF544..... ea.....5.00
'73 - '76DF1213..... ea.....5.00
'77DF962..... ea.....5.00

EXTERIOR DECALS



DF914

"Grabber" Fender Decals

'71 - '72 Orange / black.
.....DF914..... ea.....11.50
Yellow / black.
.....DF915..... ea.....10.95
Silver / black.
.....DF916..... ea.....14.50



DF816



DF815

Stallion Fender Decals

'76 - '77 LH.....DF816..... ea.....14.50
RH.....DF815..... ea.....14.50



Sprint "U.S.A." Quarter Panel Shield

Red, white and blue shield with gold trim. Applied to rear quarter panel above marker lamp.

'72DF391..... ea.....12.50

MISCELLANEOUS DECALS



DZ5

Autolite Spark Plugs Circle

4".....DZ5..... ea.....5.50
6 1/2".....DZ4..... ea.....6.50



DZ115

Ford Drag Team

5".....DZ115..... ea.....5.50
8".....DZ116..... ea.....7.50



Ford Oval

3 1/2"DF361..... ea.....5.50
6 1/2"DF362..... ea.....5.00
9 1/2"DF363..... ea.....5.50
17"DF364..... ea.....7.95



DZ114

Window Decals

"Muscle Power" inside window.
.....DZ113..... ea.....7.00
"Muscle Power" exterior decal.
.....DZ114..... ea.....7.00



1 1/2" x 2 1/2" Autolite Ford.
.....DZ120..... ea.....5.50



3" Genuine Ford Parts.
.....DF531..... ea.....4.50

Can't decide on a gift idea?

How about an Auto Krafters Gift Certificate?

They are available in your choice of dollar amount. Check online or ask your sales associate today.

NEW TITLES FOR 2015

Book Sales Policy

Once the plastic cover is unsealed on a book, it is no longer returnable.



FORD CARBURETOR SERVICE MANUAL



Compiled from multiple sources – Ford, among others, – and features plenty of detail information and diagrams for rebuilding, cleaning and adjusting Ford, Autolite, and Motorcraft carburetors.

'70 – '74 With model 2100 2/V carburetor.
2100SM ea 9.95



FORD AOD TRANSMISSIONS: REBUILDING AND MODIFYING THE AOD, AODE AND 4R70W



By George Reid. A complete step-by-step rebuild manual demonstrating the complete process of removing the transmission from the vehicle, disassembly and cleaning, reassembly, installation, and road testing. This book is great for those who already have the AOD transmission and want to add performance modifications, or for those who want to replace their old C4 or C6 in their classic machines. Includes many color photos. Sftbd.

144 pgs. B251140 ea 24.95

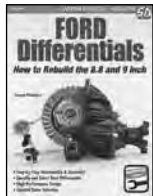

FORD DIFFERENTIALS: HOW TO REBUILD THE 8.8 AND 9 INCH



By Joseph Palazzolo. Takes you through the process of identification, disassembly and assembly of the two most popular and best high-performance differentials on the market. After many miles and high-performance use, axle assemblies need to be rebuilt. Palazzolo guides you step by step in your rebuild project. He explains the work for limited slip and open differential disassembly, inspection, reassembly and final calibration. Includes lots of color photos, illustrations and charts. Sftbd.

144 pgs. B250389 ea 24.95

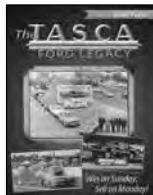

THE TASCA FORD LEGACY: WIN ON SUNDAY, SELL ON MONDAY!



By Bob McClurg, foreword by John Force. Tells the story of Bob Tasca, from his early beginnings through the growth of his car dealership, the performance years, and into more recent times. The Tasca Ford dealership became the company's premier dealership through innovative sales ideas and outstanding customer service. It also was a performance car dealer that created its own models which influenced Ford to follow through with later. This book is a great addition to the Ford fan's library. Includes many color and B&W photos. Hdbd.

192 pgs. B251287 ea 34.95



OWNER'S MANUAL

'71 71MAVOM ea 16.95

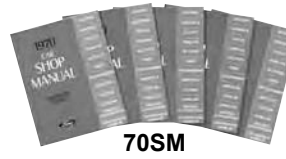

70SM

SHOP MANUALS – REPRINTS

Covers all models of Ford and Mercury passenger cars for the given year. These 5-volume sets lay out technical information required to maintain vehicle performance: volume 1 covers the chassis, volume 2 covers the engine, volume 3 covers electrical, volume 4 covers the body, volume 5 covers pre-delivery, maintenance and lubrication. All manuals are full-sized reprints authorized and licensed by the Ford Motor Company®.

'70 70SM..... set.....	69.95
'71 71SM..... set.....	69.95
'72 72SM..... set.....	69.95
'73 73SM..... set.....	69.95



SHOP MANUALS – CD-ROMS

Unless otherwise noted, these informational CD-ROMs contain the factory shop manuals and master parts catalogs, including illustrations, sales brochures and other historical vehicle facts for the years specified. Search for parts using categories such as brakes, sheet metal and more. View part locations from the master parts catalog.

Print reference pages as needed.

Requires Microsoft® Windows® XP or later, Apple® Macintosh® OS X Snow Leopard (version 10.6 – Intel® processor only) or later, CD drive, and Adobe Reader or other PDF reader. NOT RETURNABLE.

'70	Ford cars CD70FDCAR ea 39.95
'71	Ford cars CD71FDCAR ea 39.95
'72	All Ford cars CD72FDCAR ea 39.95
'72	Mercury cars CD72MCCAR ea 39.95

Shop Manual and Wiring Diagrams Only

'73	All Ford cars CD73FDCAR ea 39.95
'74	All Ford cars CD74FDCAR ea 39.95

Shop Manuals Only

'75 – '76	All Ford cars CD75FDCAR ea 29.95
'77	All Ford cars CD77FDCAR ea 29.95



CDSM70

SHOP MANUALS ONLY – CD-ROMS

Contains the original shop manuals used by Ford mechanics, reproduced in electronic form. Includes illustrations, photographs and diagrams.

Requires Microsoft® Windows® XP or later, Apple® Macintosh® OS X Snow Leopard (version 10.6 – Intel® processor only) or later, CD drive, and Adobe Reader or other PDF reader. NOT RETURNABLE.

'70	Maverick CDSM70 ea 21.95
'71	Maverick CDSM71 ea 21.95
'72	Maverick CDSM72 ea 21.95
'73	Maverick CDSM73 ea 21.95



AUTO KRAFTERS, INC. GOLD CARD CLUB

- Save 10% on our already low prices*
- Get expedited order shipping
- \$9.95 flat shipping on orders*

JOIN THE AUTO KRAFTERS GOLD CARD CLUB TODAY!

Ask your salesperson for more information!

*Some exclusions apply.



FMX AUTOMATIC TRANSMISSION DIAGNOSIS, SERVICE AND TRAINING MANUALS – CD-ROM NEW

Three Ford manuals in one CD-ROM. Includes *FMX Automatic Transmission Diagnosis and Service (Course 1715-108)*, *FMX Transmission Principles of Operation (Course 1715-106-INN1)*, and *Automatic Transmission Diagnosis – Programmed Instruction Book (Volume 70 S6-L2, Course 7530)*. These manuals were used to instruct Ford techs in the operation, diagnosis, and service of FMX transmissions. With step-by-step procedures, the manuals contain material that was in effect at the time of approval for printing. Officially licensed by Ford.

Requires Microsoft® Windows® XP or later, Apple® Macintosh® OS X Snow Leopard (version 10.6 – Intel® processor only) or later, CD drive, and Adobe Reader or other PDF reader. NOT RETURNABLE.
 CD10174.....ea 12.95



FORD SHOP TIPS MAGAZINES 1963-1973 – CD-ROM

A complete 10-year collection of *Shop Tips* magazine, a Ford technical service publication provided to servicemen in service stations and independent garages to help mechanics with the servicing of Ford vehicles. Begins with the October 1963 issue and ends with August 1973. Each issue is jam-packed full of shortcuts, tips, and tricks to make repairs fast and easy. Covers both car and truck models. Officially licensed by Ford.

Requires Microsoft® Windows® XP or later, Apple® Macintosh® OS X Snow Leopard (version 10.6 – Intel® processor only) or later, CD drive, and Adobe Reader or other PDF reader. NOT RETURNABLE.
 CD10062.....ea 14.95

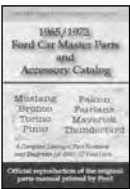

FORD CAR MASTER PARTS AND ACCESSORY CATALOG – DVD-ROM

The original Ford master parts catalog, with all part numbers and illustrations for 1965-72 cars and 1966-72 Broncos, in electronic form. Includes explanations for the Ford parts numbering system, warranty plate and certification label info, body codes, hard parts, soft trim, sheet metal, exterior and interior trim colors and much more.

Over 6,000 pages, 10,000 part numbers and 1,000 diagrams. Features printable pages in a high-resolution format.
 Requires Microsoft® Windows® XP or later, Apple® Macintosh® OS X Snow Leopard (version 10.6 – Intel® processor only) or later, CD drive, and Adobe Reader or other PDF reader. NOT RETURNABLE.
 FCMP6572.....ea 24.95



1962-76 FORD COMPONENT BUILD DATE MANUAL

Includes ID codes and date stamp locations for engines, automatic transmissions, electrical components, heating and air conditioning, chassis, steering, suspension, axles, brakes, shocks and body. Line drawings and tables. Sftbd.

12 pgs..... MP377.....ea 8.95



HIGH PERFORMANCE FORD ENGINE PARTS INTERCHANGE

By George Reid. *Revised and updated.* Covers 9 small-blocks and 12 big-blocks, 221 through 460 CID, including Cleveland and Windsor IDs; casting numbers on SVO components, cylinder heads, blocks, cranks, rods, and cams; carburetor IDs; and much more. This extensively-researched book also includes critical information and

great detail on the highly desirable, high-performance hardware throughout the '60s, '70s and '80s. By following its advice and combining some of the best parts from various years, some great performance potential can be unlocked in ways Ford never offered to the general public. Sftbd.
 160 pgs. B127910ea 29.95



FORD HIGH PERFORMANCE PARTS IDENTIFIER

By Robert M. Winkelman. Authenticate any high-performance engine! This pocket-sized book lists casting numbers on engines, engine components, transmission and differential. An invaluable reference.

88 pgs.....BOOK10.....ea 9.95



AMK PRODUCTS GUIDE TO FORD FASTENERS 1955-73

Representing four years of research and composition, this volume covers the majority of 1955-73 Ford car and truck threaded fasteners, as well as hose clamps and many other common non-threaded fasteners. The book's primary purpose is to assist the Ford restorer in identifying original equipment fasteners found on their vehicles. Contents include: 10,000 items, history, finishes, measuring, grades, and refinishing. Sftbd.

274 pgs. 9657662.....ea 39.95



HOW TO REBUILD THE SMALL-BLOCK FORD

By George Reid. Takes you through the step-by-step process of rebuilding a small-block Ford engine. Go from planning your rebuild, disassembly, and inspection through choosing the right parts, machine work, assembling your engine, first firing and break-in. Gives helpful hints and tips on performance upgrades, including cams, heads, ignition and more. Covers Ford engines 221, 260, 302, Boss 302, 351W, 351C, 351M and 400M. 600 illustrations. Sftbd.

144 pgs. B932494ea 24.95



FORD WINDSOR SMALL-BLOCK PERFORMANCE

By Isaac Martin. Revised 2nd edition. A comprehensive guide to the tips, tricks and techniques of top Ford performance experts that will help your Ford or Mustang run harder and faster, leaving that "other small-block" at the starting line. Engine building techniques are included for street machines, drag racers, tow vehicles – for just about any Windsor-equipped Ford. Whether you have a 289, 302 / 5.0L or 351W / 5.8L, this is your guide to performance success – on or off the strip. Sftbd.

186 pgs. B129494ea 24.95



MUSCLE CAR & HI-PO ENGINES

From *Hot Rod* magazine comes tips for "tuning up" as well as power secrets of the fabulous muscle engines of the '60s and '70s. Information and advice packed into over 20 different articles on how to increase horsepower for your muscle car. 180 illustrations. Sftbd. 100 pgs.

Ford 289, 302, Boss 302, 351W. B116664ea 24.95
 Ford 351C and Boss 351..... B116661ea 24.95

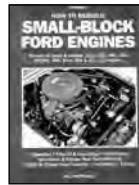

HOW TO REBUILD SMALL-BLOCK FORD ENGINES

By Tom Monroe. Complete guide to rebuilding any 221, 260, 289, 302 and 351W Ford engine. Includes: how to remove engine, repair and recondition, as well as assemble and install. 567 illustrations. Sftbd.

160 pgs..... 45089ea 24.95



HOW TO REBUILD BIG-BLOCK FORD ENGINES

By Steve Christ. This book begins with the essential question: Do you need to rebuild? Once rebuilding has been decided, the author guides you chapter-by-chapter through engine removal, parts identification and interchange, teardown, short-block reconditioning, cylinder head reconditioning, reassembly, installation and tuneup. Covers all FE and FT Series Ford engines – 332, 352, 360, 390, 410, 417, and 428 – as well as Ford medium- and heavy-duty truck engines 330HD, 330MD, 359, 361, 389 and 391. Sftbd. 475 illustrations.

160 pgs. 40070ea 24.95



HOW TO REBUILD FORD V8 ENGINES

By Tom Monroe. Covers rebuilding of 351C, 351M, 400, 429 and 460. Helps you identify problem areas and demonstrates tear-down and inspection procedures. Covers parts identification, short-block and cylinder head reconditioning, tune-up, carburetor and distributor rebuilding, assembly and installation. 559 illustrations. Sftbd.

160 pgs. 40036ea 24.95

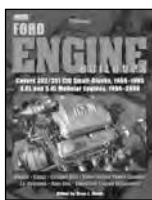

FORD ENGINE BUILDUPS 302, 351, 4.6, 5.4

Compiled by the expert tech editors and writers at *Muscle Mustangs and Fast Fords* magazine. This book features 20 chapters of the latest technical information on how to build horsepower for the 302 small-blocks to the 4.6 L and 5.4 L modular V8s. Buildups include a target goal of performance and horsepower levels, a list of components, and combinations on how to achieve them. Covers 1968–95 302 / 351 small-blocks and 1996–2008 4.6 L / 5.4 L modular engines. Sftbd.

154 pgs. HP1531ea 24.95



HOW TO REBUILD AND MODIFY FORD C4 AND C6 AUTOMATIC TRANSMISSIONS

By George Reid. A complete step-by-step guide to rebuilding C4 and C6 automatic transmissions. Takes you through the production history to make you aware of changes you will need to know when rebuilding your transmission. Covers removal, disassembly, reassembly and installation. Also included are troubleshooting and sources chapters, and many color photos. Sftbd.

144 pgs. B709825ea 24.95

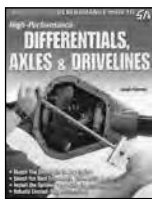

HIGH-PERFORMANCE DIFFERENTIALS, AXLES & DRIVELINES

By Joseph Palazzolo. Helps you buy and install the proper drivetrain for almost any vehicle and application. Often an owner will build a high-performance engine that the driveline components cannot handle. This guide covers everything you need to know to

select proper gear ratio, rebuild differentials and match the proper driveline components with your engine power output. Includes many color photos. Sftbd.

144 pgs. B191543ea 24.95



METAL FABRICATOR'S HANDBOOK

By Ron and Sue Fournier. This book covers body work, welding tips, hammer-forming, roll bars and roll cages, exhaust header design and construction, metal shaping tools and techniques to mention a few. Includes; detailed pictures, a glossary of industry terms and a complete suppliers index. Sftbd.

176 pgs..... B868709ea 19.95



AUTOMOTIVE BODYWORK AND RUST REPAIR

By Matt Joseph. Helps you plan and successfully repair your bodywork project. The author informs you on both simple and more difficult sheet metal repairs. This guide teaches you proper tool selection, cleaning and preparing metal, fabrication, welding and finishing. Includes many color photos. Sftbd.

160 pgs. B191546ea 24.95



PAINT & BODY HANDBOOK

By Don Taylor and Larry Hofer. Everything needed to get professional-looking results, from repairing a small dent to stripping and painting a whole car. Covers tools, welding techniques, choosing and using paint and equipment. Clear detailed photos. 350 illustrations – 16 in color. Sftbd.

144 pgs..... 40220ea 19.95



MERCURY COMET AND CYCLONE LIMITED EDITION EXTRA: 1960–1975

This book compiles numerous articles chronicling the history of the Comet line, from its origins as a mid-sized compact through its muscle car glory years, to its twilight as an economy car. Covers Comet, S-22, Caliente, Cyclone, and Montego. Includes road and comparison tests, new model reports, specifications and full performance data. Black and white photos. Sftbd.

128 pgs. B1207134ea 24.95



SUPER 60'S FORDS

By John Smith. The inside story of the most powerful Fords ever built. Covers the entire Ford performance story in the 1960s – not just Mustangs and Cobras, but Galaxies, Torinos, Falcons, Fairlanes, Shelybys, Mavericks, Thunderbirds and every other car that got extra horsepower stuffed under its hood in the '60s.

Models are covered from year to year from the super-charged Thunderbirds of 1957 to the last 1973 muscle cars. Includes information on deciphering VIN numbers and parts codes. Sftbd. Out-of-print first edition – *limited quantity*.

128 pgs. B4089690ea 29.95

DVD Sales Policy

Once the tamper seal on the DVD box has been broken, it is no longer returnable. Exceptions will be made if the DVD is defective and cannot be viewed. If you receive a defective DVD and wish to return it, please enclose a statement specifying the defect along with the disc. Defective DVD will be replaced (only) at no additional charge.

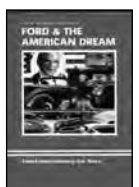

FORD & THE AMERICAN DREAM

Follow Ford through unforgettable advertisements and events from the Model Ts and the early V8s up to the 1970s. Narrated by veteran Ford voice Shelby Newhouse and written and produced by auto historian Lorin Sorensen for a 1991 Ford marketing program, this is the entertaining story of some of the best of those Ford-produced cars and historic events, compiled from the very best of the original historic film footage. In B&W and color with sound. DVD.

50 minutes..... DVD120ea 24.95

Not sure of a term used here?
Check out the Glossary in the back of this catalog.



A&E'S BIOGRAPHY®

HENRY FORD: TIN LIZZY TYCOON

Presented by A&E's *Biography*®. "The way to make automobiles is to make one automobile like another automobile, to make them all alike." With this premise Henry Ford launched the idea of the assembly line, the automotive industry, and an American dynasty. *Henry Ford* looks at the driving forces of this dynamic industrialist, philanthropist and automotive autocrat. In color. DVD.

60 minutes DVD125529ea5.99



FORD AT THE 1963-64 RACES

Great NASCAR action close-up with drivers such as A.J. Foyt, Fred Lorenzen, Junior Johnson, and Ned Jarrett. Thrill to "Tiny" Lund's amazing out-of-gas finish at the 1963 Daytona 500! Then it's off to the Indianapolis 500 with Team Lotus's Dan Gurney and Jimmy Clark. 1964 action covers races from Riverside to Daytona to the Monte Carlo Rally. Also includes footage of driver Curtis Turner and racing engineers discussing the new "Total Performance" engine and a tour of the hot rod and drag racing scenes. In color with sound. DVD.

60 minutes DVD119ea24.95



FORD AT THE 1965-66 RACES

Begins with the film *Shelby Goes Racing with Ford*, narrated by racing legend Carroll Shelby as he tells the story of his racing career and building of the Mustang GT350 and the Ford GT40. In the next film, 1965 NASCAR champ Ned Jarrett gives a tour of his shops and shows how he and his team build NASCAR winners. In color with sound. DVD.

60 minutes DVD117ea24.95



FORD WINS THE 1966-67 LE MANS

The story of Ford's challenge to Ferrari's dominance of Le Mans, France's 24-hour endurance race, begins in 1965 with Carroll Shelby in his Los Angeles shops designing the GT40 and follows through to decisive victory for teams McLaren / Amon, Miles / Hulmes, and Bucknum / Hutchinson in 1966. Then the GT40 returns to Le Mans in 1967 with Dan Gurney and A.J. Foyt driving to another victory and a new track record. Great coverage of the cars, the drivers, and all the action. In color. DVD.

54 minutes DVD116ea24.95

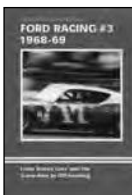

FORD AT THE 1968-69 RACES

Starts with the 1968 Ford film *No Margin for Error*, which features highlights of Ford at seven major races from Daytona to Indianapolis to Riverside. Mustang racing against Camaro in the Trans-Ams! Cale Yarborough's Cyclone wins the Daytona 500! Bobby Unser's Ford-powered racer winning the Indy 500! Lots of racing action! Also included is the 1969 film *Ford Flat Out*, which covers a wide variety of thrilling Ford racing – Mario Andretti and A.J. Foyt winning at Indy, more Mustang Trans-Am action, Mickey Thompson's Mach 1 funny car at Bristol, and more. Plus lots of NASCAR action, including Richard Petty's big win for Ford. In color with sound. DVD.

60 minutes DVD124ea24.95



Classic Drag Racing Videos



1970 SUPER STOCK NATIONALS

Begins with a look at the history of York US 30 Dragway and the Super Stock Nationals, examining the 1950s style of racing, then moves on to the most successful independent one-day race of all time, the 1965 Super Stock Nationals. Coverage continues through every year up to the 1970 Super Stock Nationals. Great camera coverage! One of the best nostalgia DVDs of all time. Fully narrated. DVD.

120 minutes DVD62ea19.95

YORK US 30 DRAGWAY DVDS

These original movie productions include rare footage of drag racing at York US 30 Drag Strip.

Psychedelic '70s, Volume 1

Features an interview with Sam Auxier, Jr. about his cammer-powered 1971 Mustang; Rich LaMont about his Boss 429-powered Maverick; Earl Wade, crew chief for "Dyno" Don Nicholson; and finally "Dyno" Don talking about his cammer-powered Maverick. This DVD is packed with cars and info, so much that there's no way list it all. DVD.

88 minutes DVD146ea19.95

Psychedelic '70s, Volume 2

Opens with a look at drag racing during the '60s and features footage of a 1965 NHRA Division 1 Record Meet. More than 68 cars are shown in this segment including Red Lane, Tasca Ford and Dave Strickler. Also featured is the 1972 Super Stock Nationals, profiling 44 cars, 33 cars from the 1973 Super Stock Nationals and finally 1979 at York, featuring 44 more cars including Joe Amato and Nick Boninfante. And last but not least, more interviews. DVD.

78 minutes DVD147ea19.95



The Super Sixties

Includes rare footage of 1964-66 and 1968-69 drag racing at York US 30 Dragway. The footage contains shots of local, regional and national level competitors. In the 1965 segment, two Super Stock and Factory Experimental races are profiled. Some of the drivers and cars are Dick Landy, Butch Leal, Arnie Beswick, Al Joniac, Moyer Mercury Comet and the Melrose Missile. The 1966 segment includes Bill Jenkins, Jerry Stahl, Bruce Larson, Huston Platt, Shirt Greer and Jack Chrisman. The 1968 segment includes the Bob Banning Dodge, Big Red Plymouth, Pee Wee Wallace, Bill Stiles and Arlan Vanke, plus many more. Real car sounds and full narration give you the most realistic sights and sounds available of the golden era of drag racing. DVD.

70 minutes DVD101ea19.95

Auto Krafters' catalogs are now available online in PDF format!

Just visit our website at www.autokrafters.com



Auto Krafters, Inc. is a long-time member of the Specialty Equipment Market Association



YORK US 30 DRAGWAY DVDS CONTINUED

**Blast from the Past**

Progresses through the 1960s, when York first began running four cars at a time on the track. See rare footage of Richard Petty and his 43 Jr. car making a pass at York. Also see a special 1970 Funny Car Match Race between Bruce Larson, Arnie Beswick, Malcolm Durham, Charlie Allen, Marv Eldridge and others. Also included is footage from a 1970 WCS point

meet with a variety of cars in all categories. The final segment is the 1970 NHRA Summer Nationals at York. This was the very first NHRA Summer Nationals meet and over 45,000 spectators turned out to see this amazing group of cars. Includes Top Fuel, Top Gas, Pro Stock, Funny Car, Competition Eliminator, Modified Eliminator, Super Stock and Stock Eliminator. DVD.

120 minutes DVD102ea 19.95

The Super Strip

Racing at York from the 1950s – 1970s. We have footage from 1957, when racing first began at York, and move along to the early 1960s and see some great cars from the mid-Atlantic region. Also in the early 1960s, York hosted some NHRA Regional Races that brought racers from all over the country to compete at the Super Strip. There is additional footage from Cecil County Drag-O-Way and New York National Speedway. The closing segment is from 1979 and the final year of racing at York. Funny cars, modifieds, stockers – this chapter has it all. Both day and night events that features Larry Fullerton's Trojan Horse Funny Car up against the Chicago Fire Jet Dragster (super cool!). DVD.

104 minutes



..... DVD148ea 19.95

LIONS ASSOCIATED DRAG STRIP, VOL. 1

Features races at the famous Lions Drag Strip at Long Beach, California. The story of the track, from its opening in 1955 until its last race on December 2, 1972, is told here. The video includes some early black and white footage along with coverage from some other California tracks. Interviews with drivers include Hubert Platt, Dick Landy, Phil Bonner and more. Real car sounds have been dubbed into the video to give it the realistic sounds of stock car racing's golden age. DVD.

118 minutes DVD136ea 19.95

**POCONO DRAG LODGE****Volume 1**

Located in Northeastern Pennsylvania the Pocono Drag Lodge (PDL) hosted drag racing from 1963 through 1971. This first of two volumes dedicated to Pennsylvania's Pocono Drag Lodge includes a recent interview with track owner Joe Perugino, plus vintage footage of racing action from 1963 through 1966. See Red Lang, Tommy Ivo, Butch Neal, Malcolm Durham, Richard Petty, "Dyno" Don Nicholson, the Platt Brothers and many more. DVD.

120 minutes DVD133ea 19.95

Volume 2

Picks up where Volume 1 ends. Features segments on S/S and FX era, early funny cars and footage of some of the drivers who were regulars at PDL. Real car sounds have been dubbed into the video to give it the realistic sounds of drag racing's golden age. DVD.

120 minutes DVD134ea 19.95

RUN WHAT YOU BRUNG – CECIL COUNTY

This DVD includes rare footage of racing events at the Cecil County Drag O Way in Rising Sun, Maryland. Features match races from 1965–67, Mr. Factory Super Stock Showdown from 1966 and a S/S and FX Invitational race from 1965. You will see some top drivers including Bud Shellenberger, Phil Bonner, "Fast" Eddie Shartman, Bill Lawton and many more. Real car sound has been dubbed in to give this DVD the realistic sounds of the golden age of drag racing. DVD.

99 minutes DVD135ea 19.95

NHRA SPRING NATIONALS 1965–1968

This DVD looks back at the first 4 NHRA Spring Nationals which were held at Bristol, Tenn. and Englishtown, NJ. Top Fuel, Top Gas, Funny Car, Super Stock, and other eliminators are included in this highly detailed DVD. Hours of research went into the script, and the result is a totally narrated tape full of historic and factual information. DVD.

118 minutes DVD132ea 19.95

THE S/S & FX ERA 1963–1967

This fully-narrated DVD contains original movie footage of the S/S and FX racers of the era. See "Dyno" Don's '64 A/FX Comet wagon, Sox & Martin's '64 A/FX Comet, Hemi's Cuda, '66 floptop Comet roadster, '67 FT SOHC Comet and many more. Also features the first and second NHRA Spring Nationals at Bristol in 1965 and 1966. Special interviews with Buddy Martin, Ronnie Sox and Jake King are also included. DVD.

80 minutes DVD131ea 19.95

**Join the Maverick / Comet Club international!**

- Meet other Maverick owners and share information
- Receive a monthly newsletter

More club information can be found in the back of this catalog.

Auto Krafter's' catalogs are now available
online in PDF format!

Just visit our website at
www.autokrafter.com



**Can't find the parts
you're looking for?**

**TRY SEARCHING OUR
WEB SITE!**

New parts are added every week!

www.autokrafter.com

Models & Related

NOTE: Due to small parts, these models are not recommended for children under 6 years old.



1:25 SCALE "OHIO" GEORGE MONTGOMERY'S MULTI-MAVERICK
From Model King®. This model can change wheel and engine position to simulate Gasser and Altered class drag cars even after the model is built. Features include Montgomery Maverick body, Chapman chassis, Ford semi-Hemi engine, 2 sets of fender assemblies with decals, and a tilt-up body. Paint and glue not included.

..... MK21749ea 29.95

Hats



COMET LOGO HAT

Navy blue hat with Comet logo embroidered in white.

..... HATCMea 18.95



HTMV-01



HTMV-02



HTMV-06

MAVERICK LOGO HATS

Black hat with Maverick logo embroidered in white and khaki edging around the brim HTMAV-01ea 19.95

Medium blue hat with Maverick logo embroidered in white. HTMV-02.....ea 19.95

Beige hat with Maverick logo embroidered in black. HTMV-06.....ea 19.95

Navy blue hat with Maverick logo embroidered in white. HTMV-08.....ea 19.95



FORD OVAL FLAME HAT

Red with black flames, black and white Ford oval.

..... HH032RBL.....ea 16.95



HH046YLW



HH046RED



HH046BLU

FORD INFERNO HATS

Black hat with black and white Ford oval and yellow flames on brim. HH046YLWea 18.95

Black hat with black and white Ford oval and red flames on brim. HH046REDea 18.95

Black hat with black and white Ford oval and blue flames on brim. HH046BLUea 18.95



WATCHMAV



WATCHMAV2



WATCHMERC



MAVERICK / MERCURY LOGO WATCHES

Metal men's quartz watch. Sporty and handsome. Features include analog display with hour, minute and second hands; seconds dial display; and a flexible, stainless wristband. Battery included.

NOTE: Does not feature date display.

Maverick Black face..... WATCHMAVea 24.95

Dark blue face WATCHMAV2ea 24.95

Mercury Light blue face..... WATCHMERCea 24.95

License Plates and License Plate Frames



LP145



LP92E-1703

EMBOSSED LICENSE PLATES

Ford oval. Blue on white LP145ea 6.95

Ford Racing logo. Red and blue on white. LP92E-1703.....ea 7.95



FORD OVAL LICENSE PLATE FRAME

High quality tripe-plated chrome with a Ford oval in each lower corner.

... WL021C.....ea 19.95

LOGO KEY RINGS



15410



14969



15226

Stainless Steel – Valet Style

Features a mirrored finish stainless steel body and a satin Ford oval name plate. Comes boxed..... 15410ea 9.95

Stainless Steel – Teardrop Style

Features a mirrored finish stainless steel body and a satin name plate. Comes boxed.

Ford 14969ea 9.95

Mercury 15226ea 9.95



Chrome

Ford oval keychain with a quality die-cast, 3" Ford oval emblem.

..... KC021ea 5.95

LOGO KEY RINGS CONTINUED



Light-Clip™

Durable black plastic features the Ford oval. A quick press on the front illuminates the bright white LED light at the bottom. Includes batteries.

..... 4251R01ea 7.95

Car Covers and Related

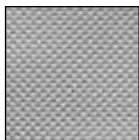

CAR COVER – BUDGELITE™ SEMI-CUSTOM® SIZE 3

This BudgeLite™ Semi-Custom® car cover is made of spun-bonded polypropylene and is strong, lightweight and breathable. Provides resistance to moisture, mold and mildew. **Caution:** Water resistance doesn't mean water proof. This car cover features grommet holes on both sides allowing it to be tied down with either a rope or cable lock. Includes an antenna patch for cars that do not have retracting antennas and storage bag.

'70 – '77 Maverick..... B3.....pr 49.95



Typical Illustration

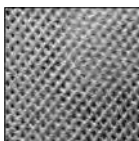

Multibond® Material

CAR COVER – MULTIBOND®

This Redi-Fit® cover is made of Multibond® which uses three-layer polypropylene construction for "better" moisture and dust resistance, and the fibers are treated for extra UV resistance. This US-made fabric offers good, basic protection and will not scratch paint.

2-year limited warranty against defects in workmanship and / or the fabric becoming unserviceable during normal use.

Available in gray only. Fits vehicles approximately 15' to 16' long.

'70 – '77 2-door.
..... C40004ea 89.95

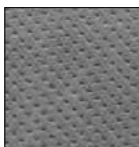

Technalon2® Material

CAR COVER – TECHNALON2®

Technalon® 2 uses four-layer polypropylene construction for maximum protection in all weather conditions. It is moisture resistant but allows air to circulate. The two middle layers act as a filtration barrier against airborne pollutants as small as fine talc. The soft inner layer will not scratch, mar or dull paint or clear coat finishes.

Limited 4-year warranty against defects in workmanship and / or the fabric becoming unserviceable during normal use.

Available in tan only. Fits vehicles approximately 15' to 16' long.

'70 – '77 2-door.
..... C80004ea 184.95



CAR COVER LOCK KIT

For use with any brand car cover. This kit includes a vinyl-coated steel cable, a padlock, non-scratch plastic snap-together grommets and iron-on reinforcing patches..... ZCLkit 9.95



FORD RACING FENDER COVER

Protect your paint job while working in the engine compartment with our logo fender covers. Black vinyl with blue and white Ford oval and red "Racing" below it. 27" x 36".

..... M-1822-A1ea 24.95



Top View

FORD LOGO GARAGE STOOL

This stool has chrome-plated legs and would be great for a garage, shop, store, game room or a work station. It also has a foot rest and a black seat featuring the blue Ford logo in white letters. Unassembled.

14" W x 29.5" H..... 4751R01ea 59.95



1721



1334

GORILLA® POWER LUG WRENCHES

Removes the tightest lug nuts with ease. Constructed from hardened steel, the telescoping handle extends to 21" for maximum leverage.

Standard Socket

Includes 2 dual sockets that fit virtually all standard lug nuts: 17 mm (3/4"), 21 mm (13/16"), 23 mm (7/8").. 1721ea 24.95

Thin Wall Socket

Includes a 3" extension and 2 thin wall sockets – 19 mm (3/4"), 21 mm (13/16") that work on both deep dish wheels and all recessed lug holes.

..... 1334ea 31.95



WINDOW MOULDING REMOVAL TOOL

Metal head with molded red plastic handle. Can be used on most Ford vehicles.

..... 2038ea 14.95



WINDSHIELD REMOVAL TOOL

This tool features a steel cable pull handle. It cuts the butyl adhesive caulking around windows with specially designed tempered steel blade.

..... WSR92065ea 24.95



BATTERY TENDER® PLUS

The Battery Tender® Plus is a 1.25 amp battery charger designed to fully charge and maintain a battery at a proper storage voltage without the damaging effects that trickle chargers may cause. Its "BTP" microchip technology applies the correct peak charge, then automatically maintains the battery at the perfect float voltage, which virtually eliminates battery-destroying sulfation! This results in a battery that is ready to go when you are and has an extended life. Features a powder coated aluminum chassis, built-in 72 hour timer that will protect a marginal battery from overcharging and is spark-proof. Works on lead-acid, sealed calcium, or gel batteries. Comes with a 10-year warranty

..... 0210128ea 74.95



BATTERY MAINTAINER

BY SCHUMACHER

Fully automatic with float-mode monitoring. Ideal for maintaining stored batteries. Keeps stored lead-acid batteries charged. Maintains the battery when fully charged and resumes continuous charging when battery becomes discharged. Features 6' power and output cords for a combined 12' reach.

1.5 amp. 6267ea 39.95



PRIORITY START

Maintain your starting power! When key is off, this device monitors, detects, and automatically disconnects any drain on the battery. Turn key to start and it automatically reconnects, starting safely from inside your vehicle. Fits any 12 volt

vehicle application PSIDP12ea 89.95

Chemicals and Adhesives



GAS TANK ETCH

Will remove light build-up of rust inside tanks and will etch the inside of the tank leaving a gray phosphate coating. An excellent prep for your tank before introducing gas tank sealer.

16 oz..... TE-01ea 19.95



ALCOHOL-RESISTANT GAS TANK SEALER

Stops rust, leaks and corrosion permanently. Resistant to all fuels, including the new Phase II oxygenated fuels. Heavily compounded with rust inhibitors. Permanently bonds to all-metal or fiberglass tanks. The only sealer on

the market approved for use in aircraft. Outsells all other sealers on the market combined.

Qt. GTS-05ea 34.95



GAS TANK REPAIR

Instant, 2-part putty. Unaffected by leaking gas. Sticks to tanks that are wet with gas. Hardens like steel in 2 to 4 hours.

0.7 oz..... GTR-1ea 4.95



GASOLINE PRESERVATIVE AND STABILIZER

The finest product on the market to prevent gum and varnish buildup in your fuel system. Primarily used to keep fuel fresh, it can also clean your fuel system, keeping injectors, needle valves, etc., free from contamination. For use in 2- or 4-cycle engines. One ounce of this product protects 3 gallons of gas or diesel fuel for 3 years. One quart will protect 96 gallons for 3 years.

Qt. FPS-01ea 19.95



QUIKSTEEL® STEEL-REINFORCED EPOXY PUTTY

A 2-part epoxy putty in one stick. Simply twist off the amount wanted and hand-knead to produce a repair material that's pliable, yet hardens in minutes for fast, permanent repairs. Bonds aggressively to metal and many other materials. After curing, QuikSteel® may be drilled, tapped, filed, or machined.

2 oz. PS2ea 4.95



SEAM SEALER

Premium quality, fast setting seam sealer with superior adhesion for interior and exterior applications (except windshields). Excellent sealer for quarter panel seams, trunk seams, wheelhouse seams, floor seams, cowl seams and door skins. Use with a cartridge applicator gun (caulking gun).

11 oz. cartridge..... AV1002ea 11.95



3M™ AUTO BEDDING & GLAZING COMPOUND – BLACK

Use for sealing auto body seams, between windshield rubber and the car body, and to attach door water shields. Remains permanently soft and pliable to absorb movement in the auto body. Non-hardening, water-resistant, medium bodied product. Cleans up with a dry cloth. Use with a cartridge applicator gun.

10 oz. cartridge 3M08509ea 15.95



WINDO-WELD™ SUPER FAST URETHANE – BLACK

This is a one-part, moisture-curing adhesive that bonds replacement auto glass to car bodies. Please read all label directions before using. Use with a cartridge applicator gun (caulking gun).

10.5 oz. cartridge..... 3M08609ea 22.95



HEAVY DRIP-CHEK SEALER – GRAY

Heavy rubber-based sealer specially designed for use on vertical seams. Weathers well, does not crack or deteriorate in sunlight. Excellent adhesion to metal, paint, glass, rubber, etc. Resists gas and oil.

5 oz. tube. 08531ea 10.95



CLEAR PLASTIC AND EMBLEM ADHESIVE

Excellent adhesive for plastic repair and emblem application. May be used for interior or exterior bonding. Used for bonding metal emblems, rigid plastic parts, taillight lenses and vinyl trim strips. Strong and quick drying. One surface application.

5 oz. tube. 08061ea 12.95



WEATHERSTRIP ADHESIVE

High-quality black adhesive. Strong, flexible and rubbery. Can withstand vibration and extreme temperature variations. It can be used to bond automotive weatherstripping and is a great adhesive for holding paper, cork or rubber gaskets in place during installation. Not recommended for windshield or back glass weatherstrip.

5 oz. tube 3M08008ea 6.95



HEADS UP™ ULTRAGRIP™ SUPER DUTY INTERIOR ADHESIVE

Designed for a variety of interior applications. Transparent and low odor, this spray adhesive is very effective when bonding to such surfaces as carpet, side panels and speaker boxes. Also bonds well to wood, fabric, paper and plastic. NOT designed for high temperature applications. Not recommended for headliner installation or repair. Contains no chlorinated solvents.

16.5 oz. aerosol..... HU98090ea 9.95



82019



3M08031

TRIM ADHESIVE

Recommended for installation of carpet, headliners, upper quarter trim panels, hood insulation, trunk mats, etc. Also recommended for repair of sunvisors or anywhere you need a good adhesive. Available in either aerosol or by the tube.

16 oz. aerosol..... 82019ea 9.95

Fast Tack 5 oz. tube 3M08031ea 12.95



BLACK STRIP-CALK

Soft, non-hardening caulking material in one-foot lengths for use in all types of seams, joints and openings. Easily thumbed into place and smoothed with finger. May be painted immediately. Has non-sag consistency for vertical and overhead applications. No shrinkage. Adheres to metal, paint, glass and rubber. Completely waterproof. Will not crack or dry out.

Box of 60 one-foot lengths..... 08578ea 19.95

NOTE: Aerosol products cannot be shipped via air.

Paints and Related



MIRACLE RUST REMOVER AND METAL PREP



The very best product on the market for removing rust. Not only will this liquid product safely and quickly remove rust, but it will leave a gray phosphate coating on the metal to provide an excellent base for painting and welding conductivity. Can be sprayed to areas from which it is normally impossible to remove rust. Etches aluminum, brass, copper and chrome plate to prep for painting. Removes nickel-plate, yet will not harm painted surfaces. Non-flammable, non-toxic, biodegradable. One-step process. Reuseable.

20 oz. spray RR-1000.....ea 19.95



PERMATEX® RUST TREATMENT

Destroys rust on contact. Provides one-step rust treatment that destroys old rust and prevents new rust. Just spray on. Within minutes, rust is replaced by a durable, black polymer coating that may be painted. Excellent protective primer. Can be used when temperature is between 50° F and 90° F (10° C and 32° C) and on surfaces which do not exceed 200° F (93° C).

10.25 oz. spray 81849ea 8.95



PLASTI-KOTE® ANTI-RUST PRIMERS

Offers optimal corrosion protection when used in combination with Plasti-Kote® anti-rust topcoat. Fast drying. Does not need to be sanded. Can be recoated any time. 12 oz. aerosol can.

Gray..... SP391ea 7.95
Black..... SP393ea 7.95

SP393



RP102



RP103

HI-TEMP EXHAUST MANIFOLD PAINT

This cast-iron gray paint is specially formulated to withstand temperatures up to 1,200° F. A must for exhaust manifolds, as it will keep it looking new for years or make old, rusty ones look factory fresh. Also looks great on headers.

12 oz. aerosol RP102ea 12.95

OEM DETAIL / CHASSIS PAINT

This black OEM detail / chassis paint has a semi-gloss finish and has a high pigment content for superior coverage.

12 oz. aerosol RP103ea 10.95



SUPER BLACK CHASSIS PAINT



The finest black chassis, undercarriage and under-hood paint made yet. Semi-gloss black finish. Withstood a 550-hour salt spray test with no visible breakdown. For spray or brush application. Absolutely unmatched by anything yet made.

16 oz. aerosol CHPT-01A.....ea 19.95



PLASTI-KOTE® ENGINE PRIMER

Resists temperatures up to 500° F (260° C). It chemically bonds to metal and will not burn off, chip, or peel. It is gasoline and oil resistant. Gray.

16 oz. aerosol SP228ea 6.95



SP205



215

PLASTI-KOTE® ENGINE PAINT

For use on valve covers and air cleaners. This enamel is highly resistant to oil and gasoline. Dries fast to a protective film that actually improves with age. When properly applied, will not crack, peel or flake off. Aerosol.

Ford blue, 16 oz..... SP205ea 6.95
Low-gloss black, 11 oz..... 215ea 6.95



135EA



361

RUBBERIZED SPRAY UNDERCOATING

This is a heavy-duty rubberized undercoating formulated to offer excellent protection, coverage and durability. Combines the flexibility and sealing properties of rubber with superior coating thickness.

16 oz. aerosol 135EAea 5.95

PLASTI-KOTE® ANTI-RUST SPRAY ENAMEL

Use this enamel in the engine compartment or for any low-gloss black application. This paint resists rust and corrosion when used over anti-rust primer. Can be used on interior and exterior, is super-durable, and you can re-coat anytime. Semi-gloss black.

12 oz. aerosol 361ea 10.95



SP285



SP125



SP127

PLASTI-KOTE® CAST GRAY FINISH ENAMEL

This rebuilder's cast gray finish is a fast-drying enamel that resists oil, brake fluid and gasoline. Recommended for master cylinders, engine blocks, idler arms and brackets, strut rods, pitman arms and spindles. Withstands heat up to 500° F.

12 oz. aerosol SP285ea 8.95

VHT® ENGINE PAINTS

These VHT® 550° F enamels are specially formulated to withstand corrosion, rust, salt spray and strong solvents. 11 oz. aerosol.

Matches dark Ford blue..... SP125ea 7.95
Silver SP127ea 7.95
Flat black. Perfect for painting engine blocks.
..... SP130ea 7.95
Gold. Great for use on valve covers.
..... SP132ea 7.95
Natural finish (dark gray) SP997ea 7.95



D7AZ-19000A SP525 615

GENUINE FORD SPRAY PAINT

This argent silver paint can be used to refinish splash pans, valve covers and other argent silver-colored metal body parts.

13 oz. aerosol..... D7AZ-19000Aea 19.95

VHT® CHROME PLUS SPRAY PAINT

VHT Brilliant Metallic Paint is a unique, quick-dry formulation that produces a metallic appearance on metal, glass, or wood surfaces.

11 oz. aerosol..... SP525ea 8.95

PLASTI-KOTE® CHROME BUMPER PAINT

This fast-drying paint has a chrome-like finish and a brilliant luster.

12 oz. aerosol..... 615ea 8.95

Cleaners



MIRROR GLAZE® VINYL & RUBBER CLEANER / CONDITIONER



A complex formula that cleans, penetrates and rejuvenates, vinyl and rubber surfaces. Durable protection that screens out damaging UV rays. Restores life and color. Leaves a rich, natural sheen, unlike the shiny synthetic coating of simple protectants.

16 oz. spray..... M4016ea 12.95



RAIN-X®

Seals, polishes and protects glass and plastic windshields. Makes water bead for aerodynamic runoff. Increases all-around visibility.

7 fl. oz. bottle..... RX712ea 5.95



PLASTX CLEAR PLASTIC CLEANER AND POLISH



This rich gel formula restores optical clarity to rigid and flexible clear plastics. Cutting edge advancements in Meguiar's® exclusive Microscopic Diminishing Abrasive® Technology (MDAT) remove light oxidation, chemical degradation, surface contaminations, stains and light surface scratches with ease.

Special highly water-resistant polymers provide long lasting durable protection to keep your clear plastics clear and beautiful longer.

10 oz. bottle..... G12310ea 9.95

Waxes and Polishes



EAGLE ONE® NEVR-DULL®

Wadding polish for cleaning and polishing all metals, including silver, gold, brass, copper, pewter, glass, steel, aluminum and chromium. Removes rust and corrosion instantly. Nevr-Dull® removes rust and tar from automobile and motorcycle chrome. Leaves no deposit

in the crevices of metal work. Excellent for mag and chrome wheels, boat fittings, workshop tools, fishing gear, sinks, showers and campers.

5 oz. 1035605ea 7.95



MIRROR GLAZE® SHOW CAR GLAZE



A pure polish that nourishes the paint for a dazzling, wet-look, show car shine. Safe and effective on all paint surfaces including clear coats. Does not build up with repeated use.

16 oz..... M0716ea 12.95



NXT GENERATION™ TECH WAX



Gives your vehicle a darker, richer, deeper and clearer shine than any other wax on the market. With new engineered synthetic polymers technology that bonds to your paint tougher to provide extreme protection. You will be amazed at how easily it glides on and off. This is a must

have if you are entering car shows, or just showing off.

18 oz. bottle G12718ea 17.95



PACIFIC COAST CAR DUSTER



Its cotton fiber dusting head, heat-treated with paraffin wax, will pick up dust and dirt from your vehicle. Safe on all surfaces. Just lightly sweep the duster over your vehicle. Reusable and can be occasionally hand washed.

Includes heavy duty plastic handle and vinyl storage bag.

NOTE: This is not a polishing tool. Excess pressure may cause paraffin deposits on vehicle's finish..... 93007ea 16.95



MICROFIBER CAR DUSTER



Super soft and will collect dust from most surfaces on cars, trucks, RVs, and boats. Features a sturdy plastic handle with a hand grip. It measures 25 inches overall in length and comes with a storage pouch. Safe to use on all surfaces.

..... 25616ea 19.95



CALIFORNIA™ CAR DUSTER



Removes dust and surface dirt with a quick once-over. The special baked-on paraffin wax-treated cotton fiber strands "lift" dust without scratching paint. 24" long with a durable plastic handle. Comes in a hard plastic, wall-mountable storage case.

..... 62439ea 24.95



WATERBLADE



2010

WATER BLADES

Patented T-bar edge whisks away water. Soft grade silicone blade will not scratch. Virtually eliminates messy towels and chamois. Dry your car or truck in one-third the time.

12" long, flexible handle WATERBLADEea 24.95

11" long, rigid handle.



..... 2010ea 17.95

Not sure of a term used here?

Check out the Glossary in the back of this catalog.

1/B OR 1/V – 1 barrel.

2 & 4 DOOR SEDAN – A car with a post at the door opening.

2/B OR 2/V – 2 barrel.

2WD OR 2WD – 2 wheel drive.

3/T OR 3/S/T – 3 speed transmission.

3 OR 4/S/T – 3 or 4 speed transmission.

4/T OR 4/S/T – 4 speed transmission.

A/C – Air Conditioner.

AFTERMARKET – Not original. Made after the marketing of vehicle.

ALT. – Alternator.

ANODIZED – Plated aluminum.

APRON – Inner panels under the hood.

A/T – Automatic Transmission.

A.T.C. – Automatic temperature control.

AUTOLITE – Ford's service division in the '70s.

BATTERY APRON – Front right-hand panel (passenger side) where the battery is mounted.

BELTLINE – Also known as fuzzies, anti-rattlers, dew wipes, window felts. Refers to the beltline (mid-section) of the vehicle.

BEZEL – Finish cover, rim or outer cover.

BRAKE PROPORTIONING VALVE – Used on front disc, rear brake cars. Not used on 4-wheel drum cars. Not to be confused with a distribution block.

B/W – Borg Warner.

C4, C5 AND / OR C6 – Types of automatic transmission.

CAMMER – an engine with an overhead camshaft (OHC)

CARB. – Carburetor.

CFM – Cubic Feet per Minute (of air).

CID – Cubic Inch Displacement.

C/M – Cruise-O-Matic automatic transmission.

COMPOSITE BRAKE DRUM – Cast metal inside with steel outside.

CONCOURS – Refers to judged car show where the car is judged as it would be seen new or as stock

CORE – The part you return in exchange for a new part. Core fees are in addition to the price of the new item. The core must be complete and rebuildable to receive full core credit. Parts missing from the core will be deducted from the core fee.

COUPE – Has no post at the door opening.

COWL – Area between the hood and windshield.

CYL. – Cylinder.

DIAM. OR DIAM. – Diameter.

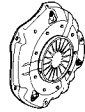

DIAPHRAGM STYLE – Type of clutch cover that uses a shallow, cone-shaped spring disc to provide pressure to the plate.

DISTRIBUTION BLOCK – At the master cylinder. Brake lines are sent out to all 4 wheels.

DURA SPARK – electronic solid state ignition

EEC – Engine Electronic Control

EFI – Electronic Fuel Injection

EGR – Exhaust Gas Recirculation.

EM/RE – Emission Reduction.

EMS – Emissions.

ESCUTCHEON – A plate. Example: the cover behind a door handle.

EV/EM – Evaporative Emission.

EXH. – Exhaust.

FINNED BRAKE DRUM – Cast metal piece with fins.

F/M/S – Ford-O-Matic 2-speed transmission.

FROM SERIAL # – Refers to the number on the data plate after which a change was made in production. "TO SERIAL #" refers to a number on the data plate before which a change in production was made. Changes on the production line often occurred during a particular production year.

FULL CAST BRAKE DRUM – A full cast material without a steel layer.

GPD – Genuine Parts Distributors

GRABBER – Exterior styling package.

GT – Grand Touring.

GVW – Gross Vehicle Weight.

H/D – Heavy Duty.

HDC – Heavy Duty Cooling.

HEADER – The body panel in front of hood if applicable.

HI-PO – High Performance.

I.D. – Inside Diameter.

IMCO – Improved Combustion.

INSULATOR – Rubber or vinyl. As in engine insulator or motor mount.

I/P – Integral Power steering.

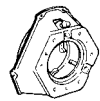

LEVER STYLE – Type of clutch cover that uses coil springs to provide pressure to the plate.

LH – Left Hand (driver's side).

MOULDINGS – NOT weatherstrip. Metal or plastic trim.

MOTORCRAFT – Ford's present-day service division.

M/S – Manual Steering.

M/T – Manual Transmission.

N.O.S. – New Old Stock.

O.D. – Outside Diameter.

OE or OEM – Original Equipment or Original Equipment Manufacturer.

OFFSET/BACKSPACING – Distance from the wheel mount to the outside rim.

PCV – Positive Crankcase Ventilation.

PHB-AC – transmission tag code (example)

PILLAR POST – The pillar at the front wind-shield.

PLENUM CHAMBER – Directs heated air to the defroster or passenger compartment.

P/S – Power Steering.

QUARTER – Rear fender.

QUARTER PILLAR – The pillar at the front of the rear quarter or at the rear of the door opening.

REQ. – Requires.

RH – Right Hand (passenger's side).

ROTUNDA – Ford's service division in the '60s.

S/C – Standard Cooling.

S.M.CO. – Specialty Motor Company.

SPREAD BORE – A carburetor that has a small primary venturi and a larger secondary venturi that provides fuel efficiency and greater acceleration.

S/T – Standard Transmission.

STD. – Standard.

TACH. – Tachometer.

T/E – Thermactor Emission.

TO SERIAL # – Refers to the number on the data plate before which a change was made in production. "FROM SERIAL #" refers to a number on the data plate after which a change in production was made. Changes on the production line often occurred during a particular production year.

UPHOLSTERY – NOT the complete seats. Refers to the outer covers only.

V/V – Variable Venturi

W/4/S – Warner 4-speed transmission.

WINDLACE – Vinyl or cloth trim at the door openings.

W/S – Windshield.

W/STRIP – Weatherstrip.

X/C or x/c – Extra Cooling.

!! WANTED !!

PHOTOS OF YOUR MAVERICKS & COMETS



Here is a way to get some money back from your restored Maverick or Comet!!
We need color pictures of our customers cars and trucks for inclusion in our catalogs, promotional items and our web site.

Here's what's in it for YOU!

a **\$25.00** gift certificate* for EACH photo we use on a cover

*to be used for a future purchase with us

*** What We Need From You ***

- Clear, color photos with good contrast, lighting, and pleasing backgrounds.
- Watch those shadows and light spots that wash out the color of the vehicle!! Overcast days are usually best for shooting outdoors.
- Try to choose a location away from objects that may reflect in the vehicle's finish.
- No individuals or animals should be in the photo.
- Stock or near-stock vehicles are preferred over heavily modified ones.
- Three-point (an angle with three sides of the vehicle visible) shots are preferred. Take a look at our covers for examples.
- Film photography is preferred over digital photographs.
- Please use a glossy photo finish.
- Please put vehicle info and owner contact info on the back of **each** photograph. Labels are preferred. If you do not have a label, leave the back blank.



PLEASE REMEMBER: Submitting a photo does not guarantee it will appear on a catalog cover. All cover photo submissions must go through a process of evaluation and approval before they are considered for a cover. All photos submitted become property of Auto Krafters, Inc. and will be kept on file unless the person submitting them requests that they be returned AND has included a self-addressed, stamped envelope for their return. Auto Krafters, Inc. is not responsible for photos lost in the mail. Photos we use, and issue credit for, will permanently become property of Auto Krafters, Inc. and will not be returned. \$25.00 credit memo will be issued ONLY if the photo is used on a catalog cover; no credit will be issued for simply submitting a photo. While we anticipate this program going on indefinitely, we do reserve the right to cancel this offer at any time without prior notice.

Any questions? Please call us toll-free at 1-800-228-7346 and ask for Catalog Production. Send photos and descriptive information of the vehicle (year, make, model, body style, etc.) and some info about the owner to:

Auto Krafters, Inc.
PO Box 1100 Dept. PH
New Market, VA 22844
ATTN: Catalog Production

Since 1978
AUTO KRAFTERS 

PLEASE PRINT!!!

NAME: _____

Address: _____

City: _____ State/Prov: _____ Country: _____

Zip Code/Postal: _____ Phone: _____ E-mail: _____

Type of car owned:

Year: _____ Make: _____ Model: _____ / _____ (GT or Grabber) (Circle One)
2 door or 4 door

Factory Equipment:

Engine: _____ Trans: _____ Floor or Column Shift: _____

Color: _____ Interior Color: _____ Bucket / Bench Seats _____

Other Options(list): _____

Serial Number: _____

Codes: (From Vehicle ID Sticker, Body Buck Tag, Build Sheet, etc.)

Body: _____ Color: _____ Trim: _____ Axle: _____ Trans: _____ DSO: _____

Do you own more than one Maverick / Comet?: _____ (Please attach separate sheet for each one.)

Other Information:

Please send me my newsletter by (Circle One ONLY): _____ Email _____ Post Office _____

Do you wish to be considered for state/province representative? _____

How far would you be willing to travel to attend a National Meet? _____

Membership Payment Options:

You have the choice of email or post office newsletter:

1. Joining for the entire current **calendar** year. No matter when you join in the current calendar year, you will be sent all current year back issues of the newsletter, plus the balance of this year's newsletters: **Email Newsletter = \$10.00**

Post Office Newsletter = \$20.00

Post Office Outside the USA = \$30.00

2. Joining during the current **calendar** year and submitting payment based on the schedule below. You will not receive any back issues, only the balance of the remaining newsletters for this **calendar** year:

Check one that applies below:

Join in April or May of current calendar year and receive 5 newsletters: Post Office=\$17.00 Outside the USA=\$25.00

Join in June or July of current calendar year and receive 4 newsletters: Post Office= \$14.00 Outside the USA=\$20.00

Join in August or September of current calendar year and receive 3 newsletters: Post Office=\$11.00 Outside the USA=\$15.00

Join in October or November of current calendar year and receive 2 newsletters: Post Office=\$7.00 Outside the USA=\$10.00

Join in December and your membership will be applied toward next calendar year: Pay FULL YEAR amount from Payment Option #1

All EMAIL members pay \$10.00 no matter what time of year, newsletter back issues will be emailed.

WITH THE ENCLOSED PAYMENT, I AGREE TO JOIN THE MAVERICK /COMET CLUB INTERNATIONAL, INC. I ALSO UNDERSTAND THAT MY NAME, ADDRESS, AND PHONE NUMBER MAY BE PRINTED IN THE NEWSLETTER OR RELEASED WITHOUT NOTICE AS DEEMED ACCEPTABLE BY THE CLUB OFFICERS IN RELATION TO CLUB BUSINESS.

Signed: _____ **Date:** _____

Please enclose check or money order payable to: MAVERICK / COMET CLUB INTERNATIONAL, INC.

Club Membership.....(write in amount from above) _____

Additional Window Decals.....\$1.00 each _____

TOTAL AMOUNT ENCLOSED (U.S. DOLLARS) \$ _____

Below for MCCI Use ONLY!!!

_____ Add _____ Check # _____ MO \$\$\$ _____ PD







Membership Application for The International Mercury Owners Association

New Member Renewal

MEMBERSHIP DUES: US \$40 for Continental U.S. and \$45 Canada; U.S. \$50 Worldwide. Dues paid will automatically enroll you as a member in the regional IMOA chapter in your area (where applicable). Please send check, money order or credit card to:

**INTERNATIONAL MERCURY OWNERS ASSOCIATION
P.O. Box 1245
Northbrook, IL 60065-1245**

		Card Number: _____	Sec. Code: _____	Exp. Date: _____
		Amount _____	Signature _____	

General Information (this information will be used for the Membership List)

Name _____	Spouse _____	
Address _____		
City _____	State _____	Zip _____
Phone _____	E-mail _____	
Birth Date _____	Occupation _____	Referred by _____

Tell us about the Mercurys you own

Year	Model	VIN	Condition	Color

Don't forget to enclose with this application some photos of your Mercurys, any ads you would like placed (ads are free of charge to members), any technical tip you may wish to share with the other members, or any article you have written. We will include them in a future issue of Quicksilver.

Please take a few minutes to fill out the questionnaire on back. Your opinion is important to us.

**THANK YOU FOR JOINING THE INTERNATIONAL MERCURY OWNERS ASSOCIATION
AND YOUR LOCAL REGION**

phone: 847.997.8624 fax: 847.272.1850 email: info@mercuryclub.com www.mercuryclub.com



Please do not send membership application or dues to Auto Krafters, Inc.



Member Questionnaire

The International Mercury Owners Association

Name _____

Please tell us about your Mercury(s).

Would you be willing to submit an article/pictures of your Mercury for publication in Quicksilver?

Would you be interested in displaying your car at different organized events?

Would you be interested in helping organize events in your region?

What are your areas of expertise that could be helpful in the club?

Other comments:



**10%
Discount**

**\$9.95
Flat
Shipping**



AUTO KRAFTERS, INC. GOLD CARD CLUB

For the Classic Ford Enthusiast

See details on back

----- DETACH FORM HERE -----

1 year membership – \$49.95

2 year membership – \$79.95

Name: _____

Address: _____

City: _____ State: _____ Zip: _____

Daytime Phone Number: _____ Fax Number: _____

Evening Phone Number: _____ Email: _____

Year and Type of Vehicle: _____

Please charge my credit card \$49.95 for one year \$79.95 for two years

Specify: VISA MasterCard Discover Am Ex

Credit Card #: _____ Expiration Date: _____

Print name on card: _____

Signature of card holder: _____

I am enclosing: \$49.95 for one year

\$79.95 for two years

Cash

Check

Money Order

Please enclose payment and mail to: **Auto Krafters, Inc.
PO Box 1100,
New Market, VA 22844**

Your membership card will be sent to you in the mail. Satisfaction guaranteed. If you feel this program is not for you, simply notify us in writing within 60 days. We will refund your membership fee minus any discounts already given.

Auto Krafters is your source for classic Ford parts and accessories. Since 1978, we have helped Ford enthusiasts across the world maintain their vehicles – from show cars to favorite drivers. We are proud to offer you the opportunity to become a member of the Auto Krafters Gold Card Club – an exclusive club that offers the privileges you deserve!

For only \$49.95 per year (\$79.95 for two years) you will receive such benefits as:

- \$9.95 flat shipping fee on all orders. Some exceptions apply. (See **Note 1**)
- Priority Order Handling; shipped the same day on in-stock items for orders placed before 1 p.m. ET.
- 10% discount on Internet, phone and fax orders over \$100 (excluding shipping). Must have part number(s) ready before placing phone or fax orders. Special shipping rates may apply. (See **Note 1**)
- Liberal return policy on items in sellable condition. (See **Note 2**)
- Price match guarantee on any currently advertised competitors prices. (See **Note 3**)
- Program is available for continental USA shipments only.



Membership Rules

- You must have your Gold Card Club membership number on your order form or available when you call to receive membership benefits. If your number is not present, you will not receive the benefits. No retroactive benefits to orders placed before becoming a member.
- You will be notified of any price changes on items. Balances due must be paid before shipment is made. Please make sure you give us a daytime phone number and / or email address for immediate notification.
- Back-ordered items or drop shipments are not subject to priority handling.
- Discounts not available on weatherstrip kits, fiberglass parts, rebuilds and core fees, rechromed bumpers, batteries, wheels, disc brake conversion kits, suspension kits, leaf springs, replacement glass, N.O.S. parts, A/C kits, certain early '60s dash pads ('60-'64 Galaxie, '60-'63 Falcon, '61-'66 pickup), or '66-'67 Fairlane quarter panels.
- Discounts apply to classic Ford parts only (1979 and earlier).
- Free shipping not available outside the continental US.
- Auto Krafters reserves the right to choose the best shipping method.

Note 1: Excludes shipping on weatherstrip kits, batteries, A/C kits, wheels, disc brake conversion kits, suspension kits, leaf springs, replacement glass, oversized UPS orders, and truck shipments. Free shipping not available outside the continental US.

Note 2: Items are nonreturnable after installation. Sellable condition means that the item can be put back into stock for immediate resale. Electrical items are not returnable. Defective items will be replaced under warranty.

Note 3: Must be an equivalent quality part to receive matching price.

Auto Krafters reserves the right to modify this program without prior notice.

Need a current catalog? Sign up for membership in the Auto Krafters Gold Card Club and choose up to two of the catalogs below. We will send them to you at no charge by priority mail.



- | | |
|---|---|
| <input type="checkbox"/> '64 ¹ / ₂ – '73 Mustang | <input type="checkbox"/> '60 – '70 ¹ / ₂ Falcon / '60 – '65 Comet;
<i>Also includes '60 – '66 Ranchero</i> |
| <input type="checkbox"/> '62 – '70 Fairlane / '68 – '76 Torino;
<i>Also includes '66 – '70 Comet,
'68 – '71 Montego / Cyclone,
'62 – '63 Meteor and '67 – '79 Ranchero</i> | <input type="checkbox"/> '67 – '73 Cougar |
| <input type="checkbox"/> '60 – '70 Galaxie and other
<i>full-size Fords and Mercurys</i> | <input type="checkbox"/> '71 – '80 Pinto / '75 – '80 Bobcat |
| <input type="checkbox"/> '70 – '77 Maverick / '71 – '77 Comet | <input type="checkbox"/> '66 – '77 Bronco |
| | <input type="checkbox"/> '61 – '79 F-Series Pickup |



PO Box 1100 • New Market, VA 22844-1100
(540) 740-8000 • FAX (540) 740-8011
www.autokrafters.com



Issue 2015

AUTO KRAFTERS^{INC}

214 East Old Cross Road • PO Box 1100 • New Market, VA 22844

Phone (540) 740-8000 • Fax Number (540) 740-8011 • www.autokrafters.com

Mailing / Billing Address	
Name _____	
Address _____	
City _____ State _____	
Zip _____ Daytime Phone () _____	

Shipping Address	
Name _____	
Address _____	
City _____ State _____	
Zip _____ Daytime Phone () _____	

NOTE: Please give a street address for shipping. UPS or truck lines will not deliver to a PO Box.

Customer # _____ Gold Card Club Membership # _____ E-mail _____

Vehicle Info Please check all that apply	<input type="checkbox"/> Ford Maverick (<input type="checkbox"/> Vinyl top <input type="checkbox"/> 2-door <input type="checkbox"/> 4-door <input type="checkbox"/> Grabber <input type="checkbox"/> Sprint <input type="checkbox"/> Stallion)
	<input type="checkbox"/> Mercury Comet (<input type="checkbox"/> Vinyl top <input type="checkbox"/> 2-door <input type="checkbox"/> 4-door <input type="checkbox"/> GT)
Year _____	Body Style _____ Engine _____ Transmission _____ Interior Code _____
	Interior Color _____

Page No.	Year of Vehicle	Qty.	Part Number	Description	Unit Price	Total Price of Items

Shipping and Handling Fee Chart	Sub Total																																							
<p>These are standard UPS or FedEx Ground shipping amounts for the continental U.S.A. only. Shipping quotes will be given for all air shipments and truck freight shipments upon request from the customer.</p> <table border="1" style="width: 100%;"> <tr> <th>Order Total</th> <th>Standard 7 to 10 Days</th> <th>Order Total</th> <th>Standard 7 to 10 Days</th> </tr> <tr> <td>\$0.00-\$49.99</td> <td>\$10.95</td> <td>\$350.00-\$499.99</td> <td>\$35.95</td> </tr> <tr> <td>\$50.00-\$99.99</td> <td>\$16.95</td> <td>\$500.00-\$599.99</td> <td>\$39.95</td> </tr> <tr> <td>\$100.00-\$149.99</td> <td>\$20.95</td> <td>\$600.00-\$699.99</td> <td>\$42.95</td> </tr> <tr> <td>\$150.00-\$249.99</td> <td>\$26.95</td> <td>\$700.00-\$799.99</td> <td>\$49.95</td> </tr> <tr> <td>\$250.00-\$349.99</td> <td>\$31.95</td> <td>\$800.00-Up.....</td> <td>FREE*</td> </tr> </table> <p>A \$1.50 insurance fee has been added to all orders over \$150.00</p> <p style="text-align: right;">* Except for oversized and overweight items.</p>	Order Total	Standard 7 to 10 Days	Order Total	Standard 7 to 10 Days	\$0.00-\$49.99	\$10.95	\$350.00-\$499.99	\$35.95	\$50.00-\$99.99	\$16.95	\$500.00-\$599.99	\$39.95	\$100.00-\$149.99	\$20.95	\$600.00-\$699.99	\$42.95	\$150.00-\$249.99	\$26.95	\$700.00-\$799.99	\$49.95	\$250.00-\$349.99	\$31.95	\$800.00-Up.....	FREE*	<table border="1" style="width: 100%;"> <tr> <td>Add Shipping and Handling</td> <td></td> <td></td> </tr> <tr> <td>Add Boxing Fee <i>For Dash Pads & Covers, Package Trays, Hoods, Fenders, Quarter Panels, Floor Pans, Radiators, Fuel Tanks, etc.</i></td> <td></td> <td></td> </tr> <tr> <td>Add \$5.00 Rush Special Handling Fee <i>Gives you priority over all other guaranteed orders. If we receive the order by 2:00 p.m. Eastern Time and it is in stock, it will be shipped out the same day.</i></td> <td></td> <td></td> </tr> <tr> <td>Add Va. 5.3% Sales Tax (Va. Sales Only)</td> <td></td> <td></td> </tr> <tr> <td>Total</td> <td></td> <td></td> </tr> </table>	Add Shipping and Handling			Add Boxing Fee <i>For Dash Pads & Covers, Package Trays, Hoods, Fenders, Quarter Panels, Floor Pans, Radiators, Fuel Tanks, etc.</i>			Add \$5.00 Rush Special Handling Fee <i>Gives you priority over all other guaranteed orders. If we receive the order by 2:00 p.m. Eastern Time and it is in stock, it will be shipped out the same day.</i>			Add Va. 5.3% Sales Tax (Va. Sales Only)			Total		
Order Total	Standard 7 to 10 Days	Order Total	Standard 7 to 10 Days																																					
\$0.00-\$49.99	\$10.95	\$350.00-\$499.99	\$35.95																																					
\$50.00-\$99.99	\$16.95	\$500.00-\$599.99	\$39.95																																					
\$100.00-\$149.99	\$20.95	\$600.00-\$699.99	\$42.95																																					
\$150.00-\$249.99	\$26.95	\$700.00-\$799.99	\$49.95																																					
\$250.00-\$349.99	\$31.95	\$800.00-Up.....	FREE*																																					
Add Shipping and Handling																																								
Add Boxing Fee <i>For Dash Pads & Covers, Package Trays, Hoods, Fenders, Quarter Panels, Floor Pans, Radiators, Fuel Tanks, etc.</i>																																								
Add \$5.00 Rush Special Handling Fee <i>Gives you priority over all other guaranteed orders. If we receive the order by 2:00 p.m. Eastern Time and it is in stock, it will be shipped out the same day.</i>																																								
Add Va. 5.3% Sales Tax (Va. Sales Only)																																								
Total																																								

Specify: VISA MasterCard Expiration _____

Am Ex Discover _____

Credit Card Number _____ CCV #** _____

**4 digits on front of card (Am Ex) or 3 digits on back (all others).

Print Name on Card _____

Signature of Cardholder _____

Check Method of Payment:

Credit Card

Money Order or Cashier's check

Personal or Company Check (Order held 7 days for bank clearance.)

Minimum Order Amount on Credit Card is \$20.00

ORDERING INFORMATION

Order by Phone

It's fast and convenient! For best service have all catalog and credit card information ready, then call:

TOLL-FREE ORDER LINE 1-800-228-7346
FAX NUMBER 1-540-740-8011
LOCAL NUMBER 1-540-740-8000

A \$20 MINIMUM IS REQUIRED FOR ORDERS PLACED OVER THE PHONE. Mastercard, VISA, Discover and American Express are welcome. C.O.D. shipments are not available for any items.

Mail Orders

Fill out the order blank in the back of this catalog. For fastest delivery, send a money order or cashiers check. **Personal checks are accepted but will delay the order 7 days while the check clears the bank.** Mastercard, VISA, Discover and American Express are welcome. **A \$20 MINIMUM IS REQUIRED FOR ORDERS PLACED THROUGH THE MAIL.** Be sure to include card number, expiration date, billing address, and signature of cardholder.

Fax Orders

Accepted 24 hours daily. Mastercard, VISA, Discover and American Express. **A \$20.00 MINIMUM IS REQUIRED FOR ORDERS PLACED OVER THE FAX.** Fax number is 540-740-8011.

Warranty / Exchanges

All parts are guaranteed. **Please inspect the shipment as soon as you receive it.** If you have a problem with any purchase, please call one of our associates at 800-228-7346. Many times, application problems can be quickly handled by phone, saving needless shipping expense. Should you find it necessary to return anything, a copy of our return procedures is packed with your invoice. **All claims for shortages must be made within 48 hours. No shortage claims will be accepted after 48 hours. To better facilitate our handling of returned items, please call and obtain a return authorization number. All returns must be sent prepaid. C.O.D. returns will be refused. Returns older than 30 days are subject to a restock fee. Absolutely no returns after 120 days from date of purchase regardless of reason unless covered by an extended warranty.** We reserve the right to charge a restocking fee on certain items. Special orders are also subject to a restock fee. Auto Krafters, Inc.'s liability is limited to the replacement of the product or refund of the purchase price. Installation labor costs or shipping charges are not refunded. Electrical parts are non-returnable once installed. We will replace defective units only. **Our associates are available from 9:00-5:00 Monday-Friday ET.**

Warehouse Location

Auto Krafters, Inc.'s office and warehouse are located in New Market, Va., off Interstate 81 exit 264. Go east ½ mile. PO Box 1100 • 214 East Old Cross Road • New Market, VA 22844. Our local phone number is 540-740-8000. **Sorry no personal checks accepted for showroom purchases without prior authorization.**

Store Hours (Eastern time zone)

MONDAY-FRIDAY 9:00 AM-5:00 PM
SATURDAY BY APPOINTMENT
SUNDAY CLOSED

Phone Hours (Eastern time zone)

MONDAY-FRIDAY 9:00 AM-5:00 PM
SATURDAY 9:00 AM-NOON
SUNDAY CLOSED

Shipping Charges

In the continental United States, there is a **minimum shipping charge of \$10.95.** Most orders are shipped via UPS or FedEx. Please furnish a complete street address as UPS cannot deliver to a post office box number. **We reserve the right to ship extra heavy or oversize shipments freight collect.** Hoods, fenders and quarter panels fall in this category. If you have prepaid the shipping and the order has to be shipped freight collect, we will refund your prepaid shipping. If you have any question, please call us at 800-228-7346 for assistance. **Please check all truck shipments for damage before signing the bill of lading. Once truck shipments are signed for, no claims can be made for damage.** Some parts require additional handling charges. Fragile items, such as mouldings, will be shipped in PVC tubes and will incur a \$15 handling fee. All oversized items will incur a \$10 boxing fee and / or crate charges where applicable. Please inquire about additional handling charges when ordering.

Alaska, Hawaii, Puerto Rico and Canadian orders should add 20% estimated shipping and handling with a minimum of \$20.00. Other foreign countries should add 35% with a minimum of \$20.00. Any excess will be refunded. Canadian customers are responsible for all customs brokerage fees and duties.

Customer Satisfaction

Our goal is customer satisfaction and we strive to sell the highest quality parts at competitive prices. If you encounter a problem with your order, contact us immediately so that we may resolve the problem. We want your repeat business and the business of your friends and neighbors. Most orders are processed and shipped within 24 hours of receipt. If we should need to back order any items, they will be shipped as soon as possible unless you notify us otherwise. If you require your parts delivered by a specific date, please advise us when placing your order and we will do our best to accommodate your needs.

Back Ordered Items

Due to the difficulty of keeping some items in stock, an item you order may be put on back order for later delivery. Most back ordered items can be shipped in 21 days. If you do not receive your back ordered items within the time stated on your notification letter, please call us at 1-800-228-7346 for a revised delivery date.

Origin of Parts

We sell both Genuine Ford and quality reproduction parts acquired from many sources, both domestic and foreign. We will be happy to give you the country of origin of all our parts, if known. All Ford Trademark parts sold (such as emblems, etc.) are licensed by Ford Motor Company®. **The majority of the parts in this catalog are made in the USA, are reproductions of originals and are NOT Genuine Ford.** Auto Krafters is proud to offer reproduction parts and accessories from such manufacturers as Dennis Carpenter®, Auto Custom Carpet®, Jim Osborn Reproductions®, Drake Automotive Group® and many others.

NOTE: We are not responsible for typographical errors. Prices are subject to change without notification.

NOTE: Illustrations are typical and may not be representative of the part you are ordering.

Secure online ordering @ our web site <http://www.autokrafters.com>

Auto Krafters, Inc.
PO Box 1100 • 214 East Old Cross Road
New Market, VA 22844

Copyright © 2015 Auto Krafters, Inc. All rights reserved. Printed in the United States of America. No part of this publication may be reproduced including drawings, photographs or text without the prior written permission of Auto Krafters, Inc. All statements and recommendations contained herein are based on information we believe to be reliable, but the accuracy thereof is not guaranteed.

CLASSIC FORD PARTS AND ACCESSORIES

Auto Krafters, Inc. has all the parts at **afFORDable** prices!

THREE WAYS TO ORDER!



MAIL

Just fill out the order form in this catalog and send it in.



PHONE

Call toll-free and our associates can help you with your order. Faster than mail.



ONLINE

Fast, secure shopping 24 hours a day, 7 days a week!
www.autokrafters.com

or



check us out on eBay!
seller IDs: akraft and fordcloseoutdeals

FREE
catalogs in the
continental US!
Specify year
and make

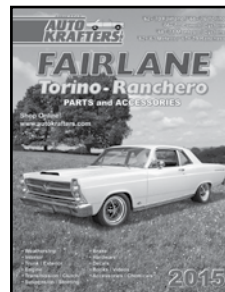

'62-'70 Fairlane
'68-'76 Torino
'67-'79 Ranchero



'60-'70½ Falcon
'60-'65 Comet
'60-'66 Ranchero



'60-'70 Galaxie and other full-size Fords and Mercurys



'64½-'73 Mustang



'70-'77 Maverick
'71-'77 Comet



'67-'73 Cougar

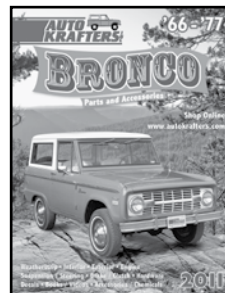

'66-'77 Bronco

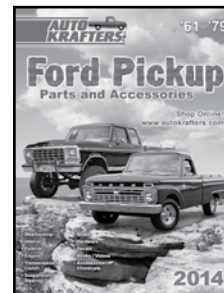

'61-'79 F-Series Pickup



'71-'80 Pinto
'75-'80 Bobcat

Auto Krafters, Inc. stocks a full line of CLASSIC FORD Weatherstrip at DISCOUNT PRICES.

We specialize in Rebuilt Power Steering Components and Steering Gear Boxes. Please call us for pricing.



NOW AVAILABLE ON CD-ROM!
ALL Auto Krafters catalogs in PDF!



Toll-free ordering, by phone or online
Visa / MC / AmEx orders
(Ask for shipping charges)

1-800-228-7346
www.autokrafters.com

PO Box 1100AP • 214 E. Old Cross Rd.
New Market, VA 22844
Fax (540) 740-8011

Since 1978
AUTO KRAFTERS!

High Quality Interior Trim! from

You've waited a long time for this, and so have we!
Auto Krafers proudly introduces the reproduction
interior trim you've been looking for!

Upholstery

All-vinyl reproductions patterned after original
samples and made using top-quality materials.

Available in original-style colors.

For more information, see page 5.



Corinthian Grain Vinyl Colors



Other colors may be
available for your
Maverick or Comet.
Please call for availability.

Door Panels

Reproductions based on original
factory panels and made using top-
quality materials with original-style
detailing.

Available in a variety of colors.

For more information, see page 6.



Also see our selection of
arm rest parts on page 6.

We've Got You Covered!



Quality Floor Covering from
the Leader in Automotive Carpet

Carpet or Vinyl
Cut Pile or Loop

We offer high-quality molded floor
covering for your classic Maverick or
Comet in a wide range of colors.

See page 7 for details.

Loop Pile Carpet Colors



Cut Pile Carpet Also Available
in Many of the Same Colors



Also see our selection of
Maverick and Comet logo
floor mats on page 8.

